

# INSTALLATION INSTRUCTIONS



## R2393W JEEP WRANGLER 03/07-ON

ENSURE INSTRUCTIONS ARE UNDERSTOOD BEFORE INSTALLATION.

**WARNING :** 1. Do not drill, cut weld or otherwise modify the towbar.  
2. If you are using electric welding on a motor vehicle, always check that the vehicle is not equipped with electronic engine or instrument management equipment. Failure to do so could destroy any onboard computers. If in doubt, check with the vehicle's manufacturer.

**Max. Towing Weight 4 door: 2300/170kg**

**Max. Towing Weight 2 door: 1600/160kg**

**NOTE: This product comes with a number plate bracketkit (8317). This kit helps to conceal the towbar when not towing. When required to tow, the number plate bracket can be flipped up & TBM inserted into the hitch box.**

1. Ensure all hardware items have been included
2. It is recommended that the instructions are read through and completely understood before making any attempt to fit this product.
3. Be wary of any changes to vehicle designs or other accessories that may conflict with the installation of this product.
4. The high tensile fasteners supplied with this product were used to achieve the specified rating. If replacement is required ensure that fasteners of the same rating & quality are used. Contact an authorised **Hayman Reese** dealer if further information is required.
5. Ensure that all hardware is fastened to torque list below check fasteners on regular basis.
6. Cut the bumper using the diagram as shown in fig 1. Drill holes through the bumper at the 4 corners of the required bumper cut & then use a saw to cut it out (Though the bumper is very thick, it is hollow inside which makes it easier to cut out).
7. The next step is to drill holes to mount the number plate hinge on the vehicle. Use the 4-M6 bolts from the bolt-kit of the 8317 number plate bracket to mount the hinge. Place the hinge on the bumper as per dimensions shown in figure 2 & locate the position for mounting the bolts & drill 6.5mm diameter holes on the bumper.
8. The next step is to flex out the bumper to fit the towbar. Remove the mud flaps on both sides by removing 3 screws. Refer figure 3.
9. Remove 2, M10 bolts behind the mud guard on both sides as shown in figure 4.
10. Remove 1, M10 bolts behind bumper over impact beam as shown in figure 5.
11. Flex out the rear bumper as shown in figure 6.
12. Loosely fit the towbar to the rear crossbeam of the vehicle through the holes shown in the figure 7 & fit the M16 & M12 bolts as shown in the diagram.
13. Tighten all bolts to torque listing.
14. Fit the number plate hinge as in figure 8 & assemble the number plate bracket as given in the fitting instructions for it.
15. Reinstall the rear bumper as in reverse of steps 8, 9 & 10.
16. Figure 9 & 10 shows the new number plate hinge on the rear bumper in such a way that it hides the bumper cut when actually not towing & can be flipped up to insert the TBM while towing.
17. **PLEASE NOTE:** Hayman Reese recommends to remove your TBM when not actually towing so as to produce a clear view of the vehicles registration plate , and to also provide maximum available departure angle.
18. Towbar load rating sticker provided with this product shall be conspicuously located on inside rear end of the driver's door. **(See diagram below).**
19. Hayman Reese recommends that you check your tow ball to ensure that it complies with the Australian standards **AS 4177.2.**

# INSTALLATION INSTRUCTIONS

R2393W JEEP WRANGLER 03/07-ON

ENSURE INSTRUCTIONS ARE UNDERSTOOD BEFORE INSTALLATION .



## RECOMMENDED ASSEMBLY TORQUE LISTING

| <u>Diameter</u> | <u>Grade 8.8 Bolt</u> |
|-----------------|-----------------------|
| M6              | 9.5 Nm                |
| M8              | 21.7 Nm               |
| M10             | 43.4 Nm               |
| M12             | 77.3 Nm               |
| M16             | 189.8 Nm              |

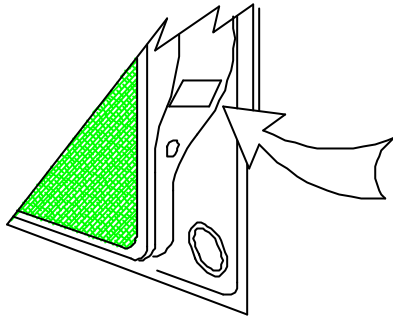

Place load rating sticker inside driver's door here

**FOR TOWING PURPOSES ONLY**  
For towing capacity details please refer to vehicle owner's manual or to the manufacturer. Overloading can void your warranties.

Fig1: Bumper cut shown below.

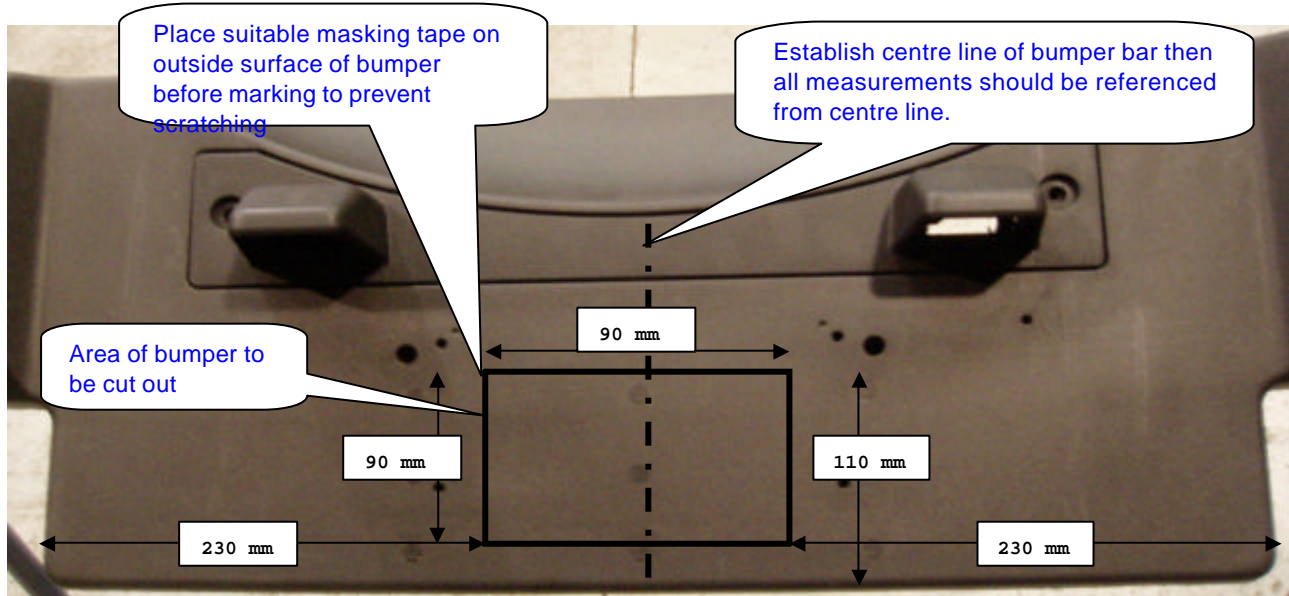
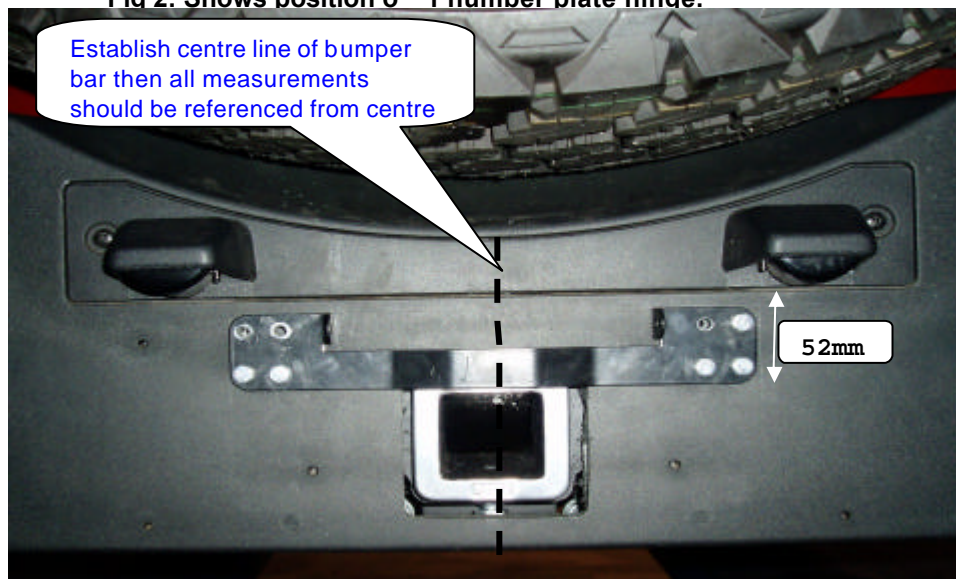

Fig 2: Shows position of number plate hinge.



# INSTALLATION INSTRUCTIONS

R2393W JEEP WRANGLER 03/07-ON

ENSURE INSTRUCTIONS ARE UNDERSTOOD BEFORE INSTALLATION .



Fig 3: Remove 3 screws on Mudflap shown.



Fig 4: M10 bolts behind mudguard



Fig 5: M10 bolts behind bumper over impact beam shown.

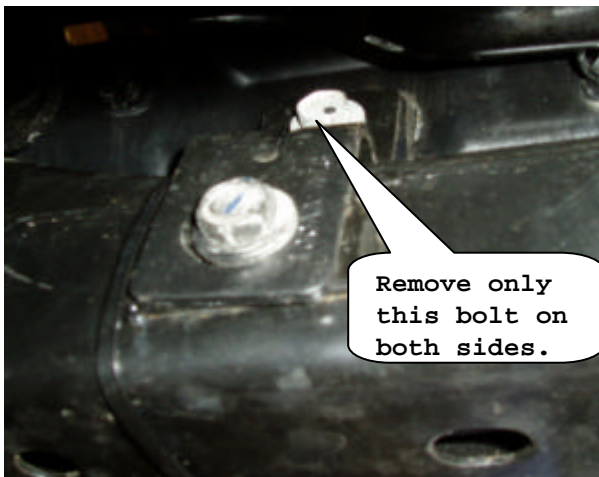

Fig 6: Shows bumper being flexed out.



Fig 7: Shows towbar being mounted on the vehicle.



Fig 8: Fitted number plate assembly.

# INSTALLATION INSTRUCTIONS

R2393W JEEP WRANGLER 03/07-ON

ENSURE INSTRUCTIONS ARE UNDERSTOOD BEFORE INSTALLATION .



Fig 9: Shows number plate bracket on vehicle, when not towing.



Fig 10: Shows number plate bracket being flipped up while towing.



## R2393 HITCH ASSEMBLY

# INSTALLATION INSTRUCTIONS

R2393W JEEP WRANGLER 03/07-ON

ENSURE INSTRUCTIONS ARE UNDERSTOOD BEFORE INSTALLATION .

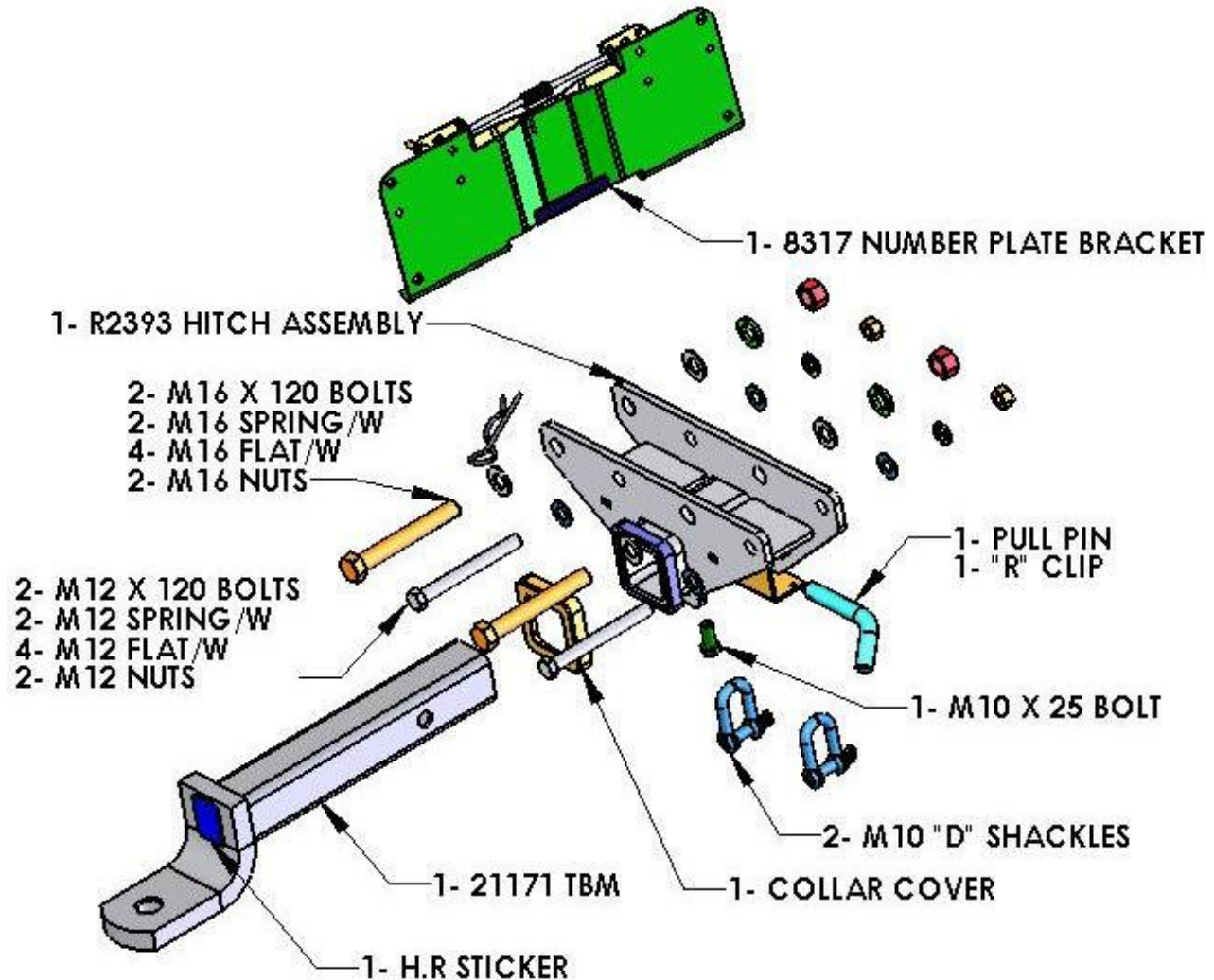

## Tow bar Maintenance and Care.

Hayman Reese recommends that bolt torque's, as listed below, are routinely and regularly inspected and checked for correct tension. Replace any worn or defective parts.

We recommended to remove Tow Ball Mounts (TBM's, tongues or lugs) when not being used for any considerable length of time.

So as to avoid injury, when not towing it is suggested that the tongue, Pull Pin and R-clip are removed then stored in a safe, clean and dry place, away from excessive moisture.

Hitch Pull Pins and spring "R" clips are regularly checked for proper installation. Replace any worn or defective parts.

**HAYMAN REESE**  
**PART No: 100017-WL**  
**JEEP JK WRANGLER**

**INSTALLATION INSTRUCTIONS**

PLEASE ENSURE THAT INSTRUCTIONS ARE UNDERSTOOD PRIOR TO FITMENT

**Wiring Loom Installation Instructions**

**JEEP JK WRANGLER**  
**Part No: 100017-WL**

**Tail Harness Length Required: 1200mm**  
**RPA Override Switch Part No: 04848 (If Fitted)**

**Wiring Loom Installation Time: Approx 15 Mins**

Issue Date 06-04-11

Page 1

Part No: 100017-WL

Hayman Reese (Cequent)  
PO Box 4050, Dandenong South VIC 3164  
Phone 1800 812 017 Email [info@haymanreese.com.au](mailto:info@haymanreese.com.au)

[www.haymanreese.com.au](http://www.haymanreese.com.au)



**HAYMAN REESE**  
**PART No: 100017-WL**  
**JEEP JK WRANGLER**

**INSTALLATION INSTRUCTIONS**

PLEASE ENSURE THAT INSTRUCTIONS ARE UNDERSTOOD PRIOR TO FITMENT

1. From the outside of the vehicle, remove the RHS tail light (1) by first releasing the 4 screws (2).
2. Repeat the above Step for the LHS.

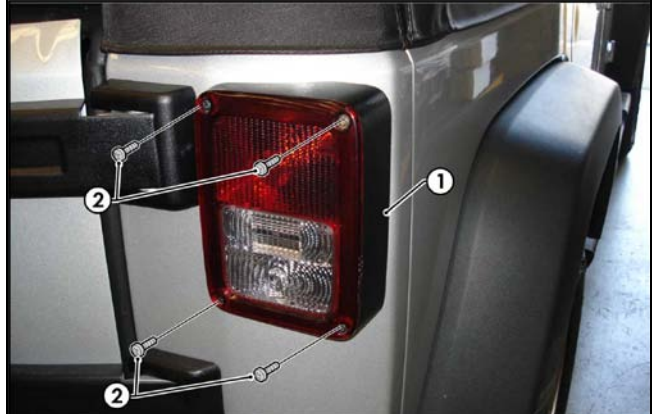

3. Disconnect the LHS tail light connectors (1).
4. Patch the Trailer Harness mating connectors (2) in between the LHS tail light connectors (1).

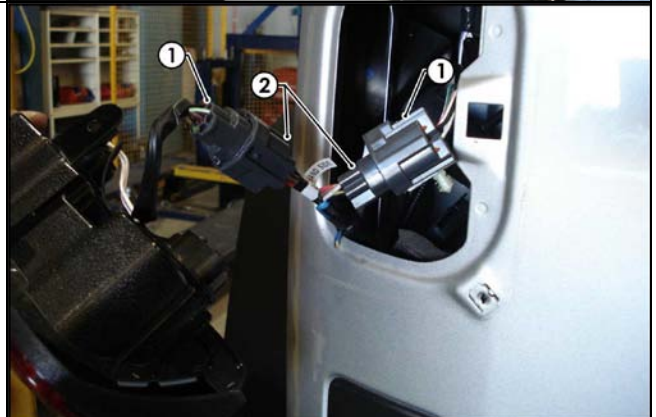

5. Route the Trailer Harness (1) (P/No: 100017-WL) along the rear of the vehicle, behind the rear bumper fascia and towards the RHS tail light.



Issue Date 06-04-11

Page 2

Part No: 100017-WL

Hayman Reese (Cequent)  
PO Box 4050, Dandenong South VIC 3164  
Phone 1800 812 017 Email [info@haymanreese.com.au](mailto:info@haymanreese.com.au)

**HAYMAN REESE**  
**PART No: 100017-WL**  
**JEEP JK WRANGLER**

**INSTALLATION INSTRUCTIONS**

PLEASE ENSURE THAT INSTRUCTIONS ARE UNDERSTOOD PRIOR TO FITMENT

6. Disconnect the LHS tail light connectors (1).
7. Patch the Trailer Harness mating connectors (2) in between the LHS tail light connectors (1).



8. Mount the trailer socket (1) to the towbar mounting bracket using M4 fasteners (not supplied).
9. Route the Tail Harness (tail length 1200mm) (2) across the towbar towards the LHS of the vehicle.

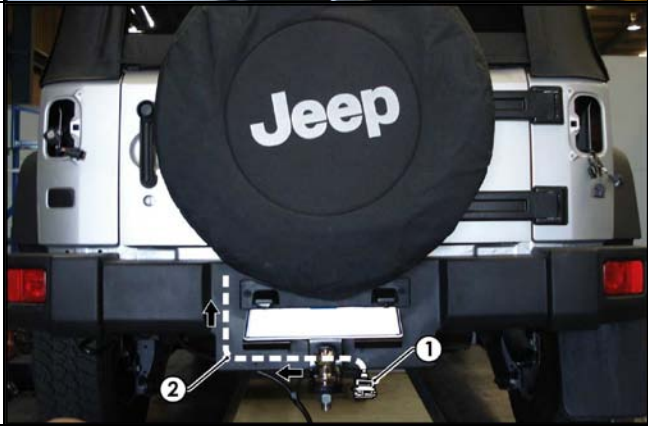

10. Connect the Tail Harness 8-way connector (1) to the Trailer Harness mating 8-way connector (2).
11. Waterproof the back of both connectors using either silicone (3) or electrical grease.

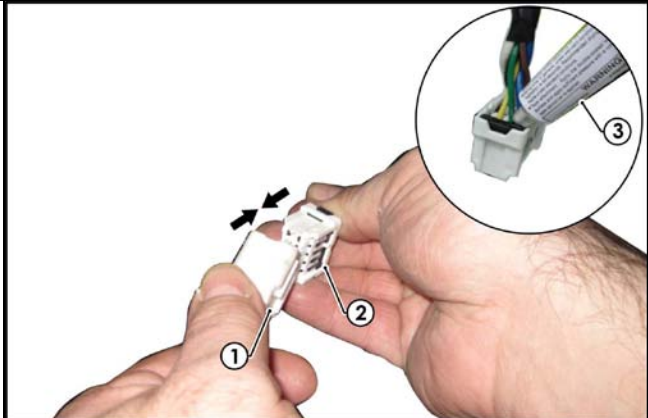

Issue Date 06-04-11

Page 3

Part No: 100017-WL

Hayman Reese (Cequent)  
PO Box 4050, Dandenong South VIC 3164  
Phone 1800 812 017 Email [info@haymanreese.com.au](mailto:info@haymanreese.com.au)

[www.haymanreese.com.au](http://www.haymanreese.com.au)





**HAYMAN REESE**  
**PART No: 100017-WL**  
**JEEP JK WRANGLER**

**INSTALLATION INSTRUCTIONS**

PLEASE ENSURE THAT INSTRUCTIONS ARE UNDERSTOOD PRIOR TO FITMENT

- |   |  |
|---|--|
| <ol style="list-style-type: none"><li>12. Test the Trailer Harness function using a Light Board or multimeter.</li><li>13. Secure all Harnesses using cables ties (not supplied).</li><li>14. Re-fit all removed parts and secure all fasteners, ensuring there are no squeaks or rattles.</li><li>15. Place the instructions in the glove box after fitment.</li></ol> |  |
|---|--|

Issue Date 06-04-11

Page 4

Part No: 100017-WL

Hayman Reese (Cequent)  
PO Box 4050, Dandenong South VIC 3164  
Phone 1800 812 017 Email [info@haymanreese.com.au](mailto:info@haymanreese.com.au)

[www.haymanreese.com.au](http://www.haymanreese.com.au)

