

HAYMAN REESE
PART No: **03064RW**
MERCEDES BENZ GL CLASS 12/12-ON
INSTALLATION INSTRUCTIONS

PLEASE ENSURE THAT ALL INSTRUCTIONS ARE UNDERSTOOD PRIOR TO FITMENT
PLACE THESE INSTRUCTIONS IN THE VEHICLE'S GLOVEBOX AFTER INSTALLATION IS COMPLETED



Installation Time: Approx **60** Mins

Towbar Installation Instructions

Towbar capacity

MERCEDES BENZ GL CLASS 12/12-ON

Part Number 03064RW

Max Towing Braked 3402 kg

Max Towing Unbraked 750 kg

Max Static Ball Load 272 kg

Hayman Reese (Cequent)
PO Box 4050, Dandenong South VIC 3164
Phone 1800 812 017 Email info@haymanreese.com.au

HAYMAN REESE

PART No: 03064RW

MERCEDES BENZ GL CLASS 12/12-ON

INSTALLATION INSTRUCTIONS

PLEASE ENSURE THAT ALL INSTRUCTIONS ARE UNDERSTOOD PRIOR TO FITMENT

PLACE THESE INSTRUCTIONS IN THE VEHICLES'S GLOVEBOX AFTER INSTALLATION IS COMPLETED

Warning:

1. Do not, drill, cut, weld or otherwise modify the towbar.
2. If you are using electric welding on a motor vehicle, **always** check that the vehicle is not equipped with electronic engine or instrument management equipment. Failure to do so could **destroy** any onboard computers. If in doubt, check with the vehicle's manufacturer.
3. If TBM is used in inverted position tow ball may make contact with rear tailgate when lowered, which could cause damage.

General:

1. Ensure all hardware items have been included refer to assembly diagram.
2. It is recommended that the instructions are read through and completely understood before making any attempt to fit this product.
3. Be wary of any changes to vehicle designs or other accessories that may conflict with the installation of this product.
4. Before drilling ensure that the area is clear of fuel, electrical & other components.
5. All holes drilled into the body panels shall have all burrs & swarf removed then coated with a suitable rust preventative paint.
6. The high tensile fasteners supplied with this product were used to achieve the specified rating. If replacement is required ensure that fasteners of the same rating & quality are used. Contact an authorised **Hayman Reese** dealer if further information is required.
7. Ensure that all hardware is fastened to torque list below check fasteners on regular basis.
8. Towbar load rating sticker provided with this product shall be conspicuously located on inside rear end of the driver's door. **(See diagram below).**
9. Hayman Reese recommends that you check your tow ball to ensure that it complies with the Australian standards **AS 4177.2**.
10. **PLEASE NOTE:** It is advised to remove your lug or tbn when not actually towing so as to produce a clear view of the vehicles registration plate if obscured, and to also provide maximum available departure angle.
11. Pull Pin must be fit in down position.

Tow bar Maintenance and Care.

Hayman Reese recommends that bolt torque's, as listed below, are routinely and regularly inspected and checked for correct tension. Replace any worn or defective parts.

We recommended to remove Tow Ball Mounts (TBM's, tongues or lugs) when not being used for any considerable length of time.

So as to avoid injury, when not towing it is suggested that the tongue, Pull Pin and R-clip are removed then stored in a safe, clean and dry place, away from excessive moisture.

Hitch Pull Pins and spring "R" clips are regularly checked for proper installation. Replace any worn or defective parts.

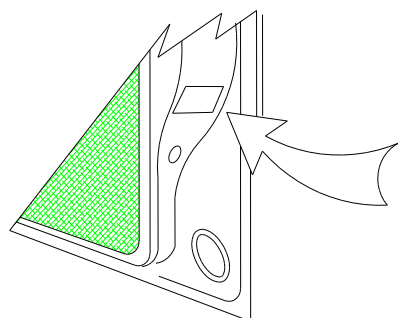

Place load rating sticker
inside driver's door here

RECOMMENDED ASSEMBLY TORQUE LISTING

Diameter Grade 8.8 Bolt

M6	9.5 Nm
M8	21.7 Nm
M10	44.2 Nm
M12	88.7 Nm
M14	146 Nm
M16	189.8 Nm

FOR TOWING PURPOSES ONLY

For towing capacity details please refer to vehicle owner's manual or to the manufacturer. Overloading can void your warranties.

HAYMAN REESE

PART No: 03064RW

MERCEDES BENZ GL CLASS 12/12-ON

INSTALLATION INSTRUCTIONS

PLEASE ENSURE THAT ALL INSTRUCTIONS ARE UNDERSTOOD PRIOR TO FITMENT

PLACE THESE INSTRUCTIONS IN THE VEHICLE'S GLOVEBOX AFTER INSTALLATION IS COMPLETED

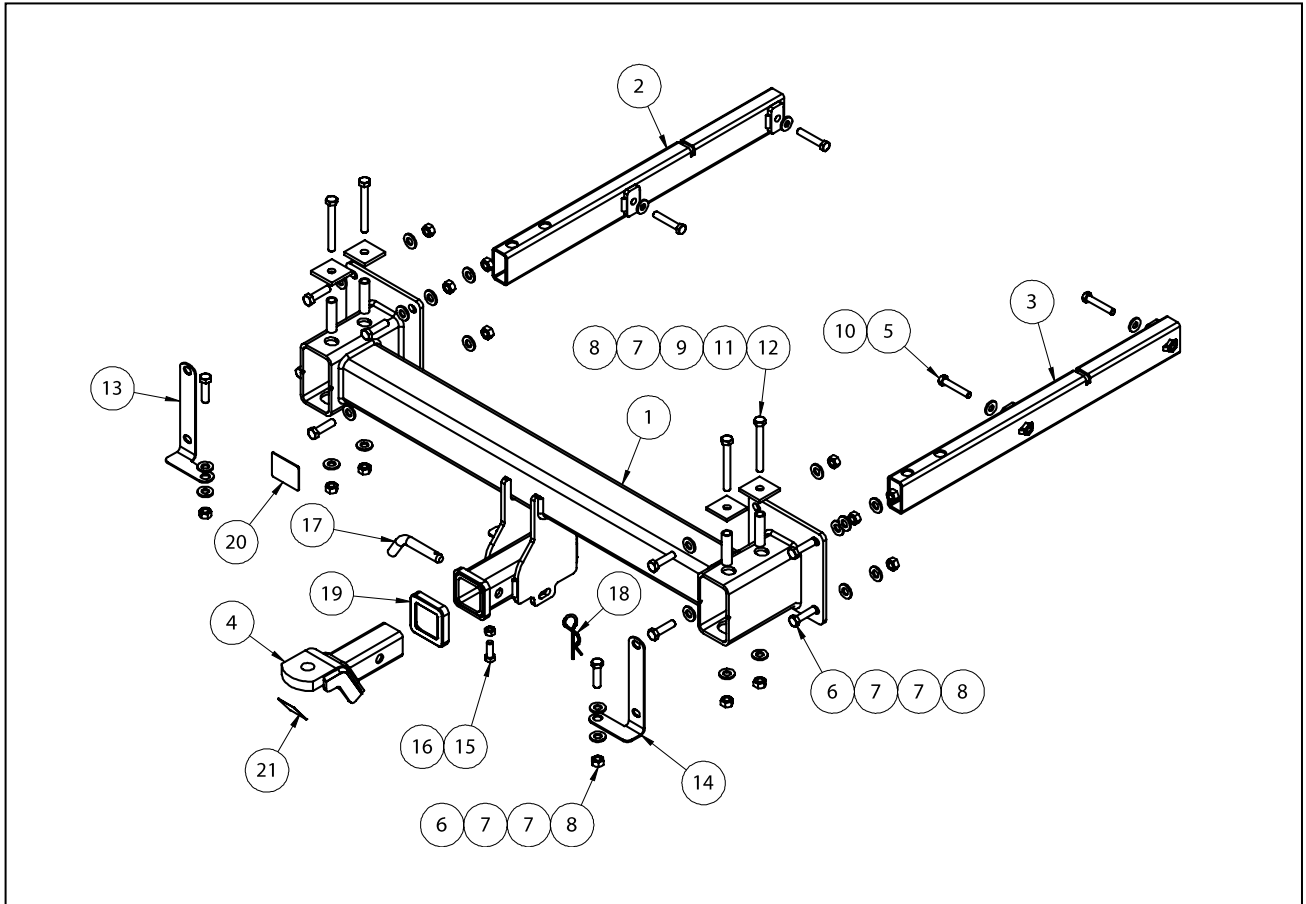

QTY	DESCRIPTION	ITEM NO
1	WELDED ASSEMBLY	1
1	CHASSIS INSERT PASSENGERS SIDE	2
1	CHASSIS INSERT DRIVERS SIDE	3
1	TBM	4
4	BOLT M10x60x1.5	5
10	BOLT M12x45x1.25P	6
24	WASHER FLAT 1/2"x1 1/8" x1/8"	7
14	HEX NUT M12x1.25	8
4	SPACER TUBE CHS17.2 ODx2.3 63mm ECOAT	9
4	WASHER FLAT M10x25.4x3	10
4	LOOSE PLATE 96208	11
4	BOLT M12-1.25 x100mm	12
1	BRKT PASSENGER SIDE	13
1	BRACKET DRIVERS SIDE	14
1	SET SCREW HEX HD M10x30x1.5P	15
1	HEXT NUT M10x1.5	16
1	PULL PIN	17
1	R CLIP	18
1	HITCH BOX COLLAR COVER	19
1	ACRYLIC COMPLIANCE PLATE	20
1	H.R STICKER	21

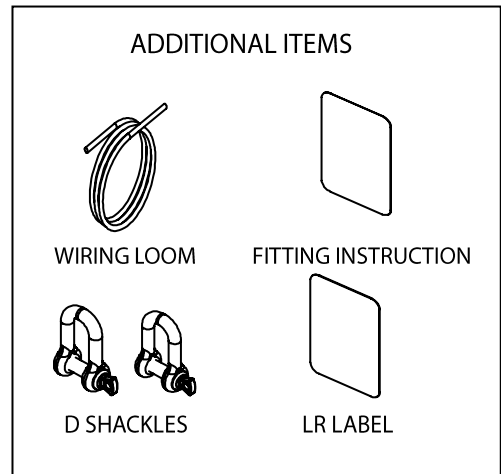

HAYMAN REESE

PART No: 03064RW

MERCEDES BENZ GL CLASS 12/12-ON

INSTALLATION INSTRUCTIONS

PLEASE ENSURE THAT ALL INSTRUCTIONS ARE UNDERSTOOD PRIOR TO FITMENT

PLACE THESE INSTRUCTIONS IN THE VEHICLE'S GLOVEBOX AFTER INSTALLATION IS COMPLETED

1. Remove the 3 push rivets securing the wheel arch to the bumper on each side.

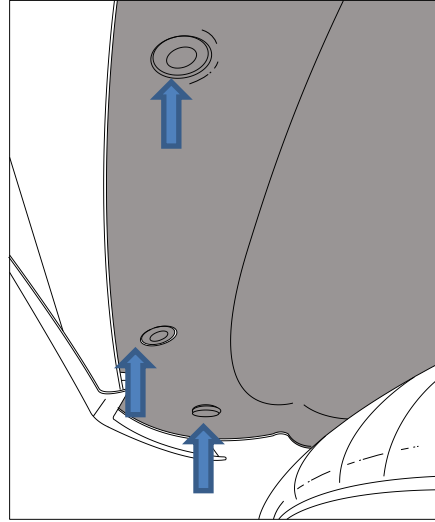

2. Remove the 1 Screw on each side holding the bumper behind the wheel arch. The wheel arch may need to be separated from the bumper using one hand to access the bolt.

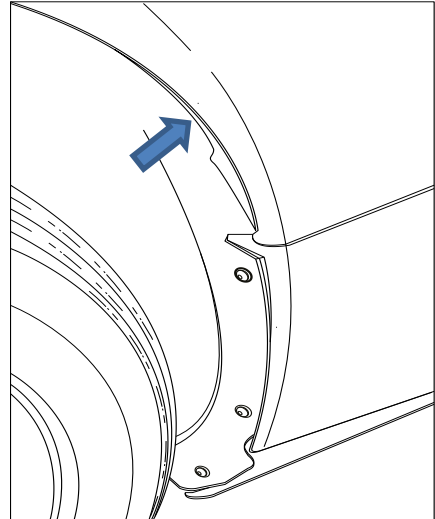

3. Remove the 1 Screw on each side attaching the bumper and mud guard to underside of vehicle.

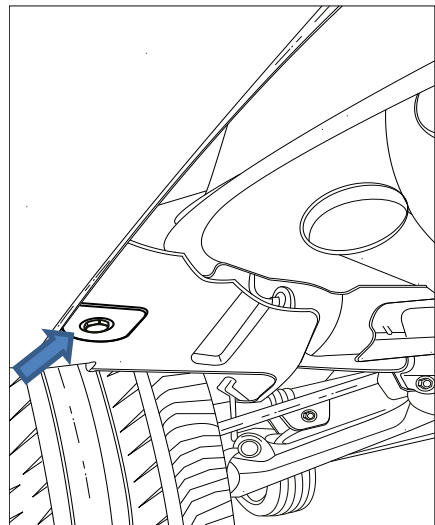

HAYMAN REESE

PART No: 03064RW

MERCEDES BENZ GL CLASS 12/12-ON

INSTALLATION INSTRUCTIONS

PLEASE ENSURE THAT ALL INSTRUCTIONS ARE UNDERSTOOD PRIOR TO FITMENT

PLACE THESE INSTRUCTIONS IN THE VEHICLES'S GLOVEBOX AFTER INSTALLATION IS COMPLETED

4. Remove the two bumper tab Screws located towards the centre of the rear underside of bumper.

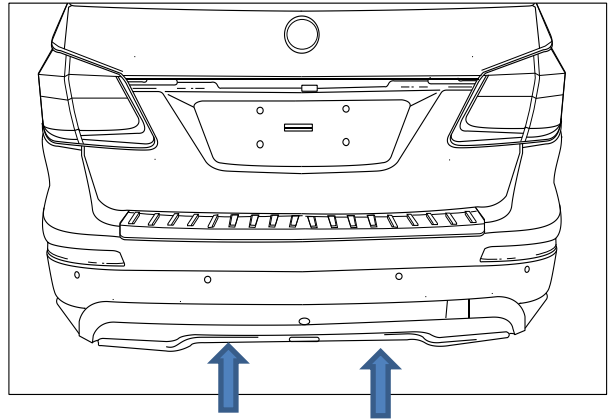

5. Remove rear bumper and impact beam from vehicle. The electrical connectors located on the passenger side of vehicle will need to be removed before the bumper can be fully separated.

Be wary of the plastic clips located under the taillights when removing rear bumper.

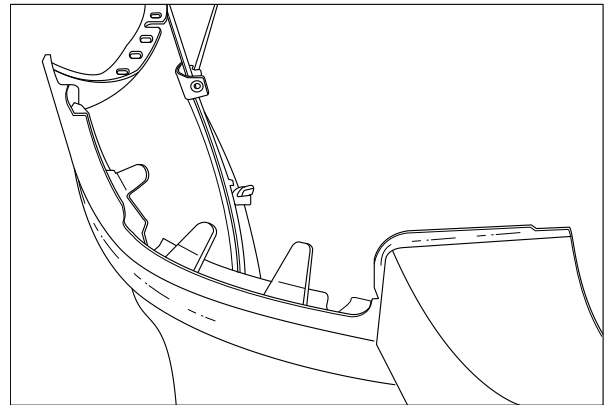

6. Remove the jack assembly and emergency equipment located in the boot compartment. Unscrew the spare wheel locator and remove spare wheel.

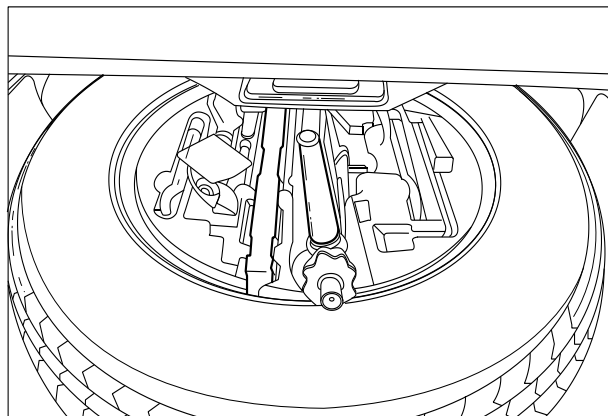

HAYMAN REESE

PART No: 03064RW

MERCEDES BENZ GL CLASS 12/12-ON

INSTALLATION INSTRUCTIONS

PLEASE ENSURE THAT ALL INSTRUCTIONS ARE UNDERSTOOD PRIOR TO FITMENT

PLACE THESE INSTRUCTIONS IN THE VEHICLES'S GLOVEBOX AFTER INSTALLATION IS COMPLETED

7. Remove the 4 Push rivets (2 each side) and 2 Screws (located on rear face) holding the carpet trim in place. Once carpet trim is removed you will be able to access the chassis rail insert mounting positions.

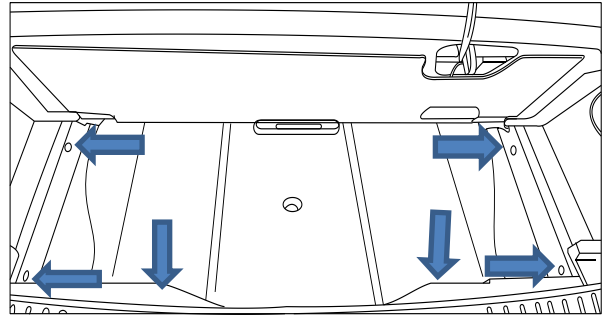

8. Place crush tubes through the chassis inserts as shown in the diagram to the right.

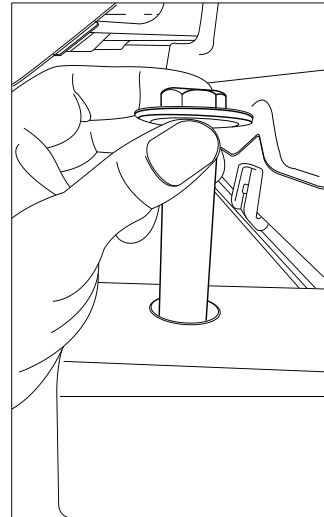

9. Slide Chassis rail insert into main assembly and loosely secure with 4 of 1x M12x100 Bolt, complete with 2x Washer and 1x Whiz Nut.

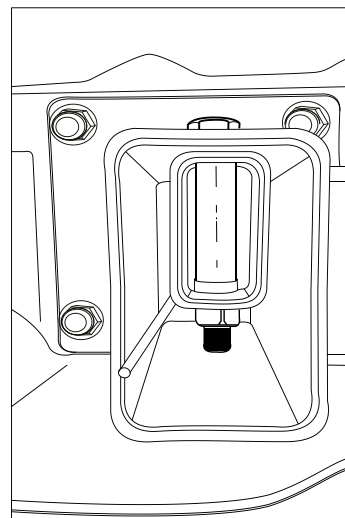

HAYMAN REESE

PART No: 03064RW

MERCEDES BENZ GL CLASS 12/12-ON

INSTALLATION INSTRUCTIONS

PLEASE ENSURE THAT ALL INSTRUCTIONS ARE UNDERSTOOD PRIOR TO FITMENT

PLACE THESE INSTRUCTIONS IN THE VEHICLES'S GLOVEBOX AFTER INSTALLATION IS COMPLETED

10. Slide Chassis inserts into Chassis Rails.

Loosely secure the most forward chassis rail mounting position using the M10X60 fastener supplied ,complete with flat washer(do this for each side).

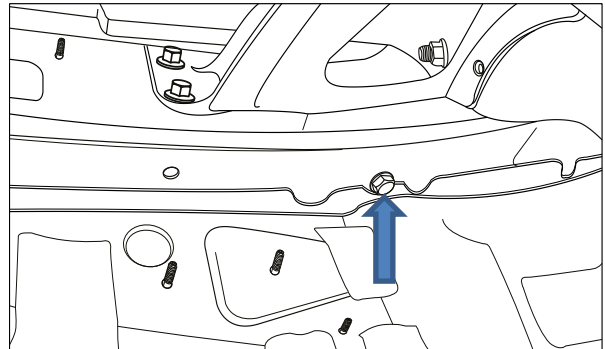

11. Loosely secure Mounting Plate to rear Panel using 8 of M12X45 Bolt , complete with 2 Washers and 1 Nut per bolt and the support Barckets.

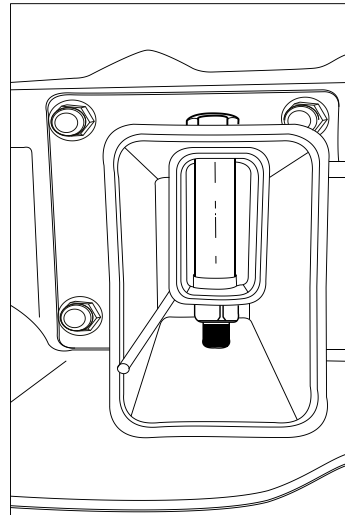

12. Align most rearward chassis insert hole with corresponding hole in the vehicle. This hole may need to be enlarged to allow for the fastener to pass through. Loosely secure with M10X60 Bolt complete with Washer.

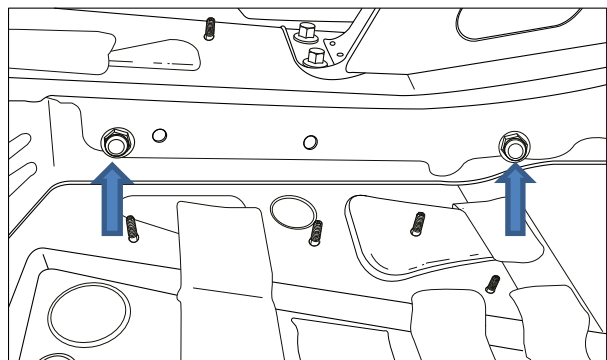

HAYMAN REESE

PART No: 03064RW

MERCEDES BENZ GL CLASS 12/12-ON

INSTALLATION INSTRUCTIONS

PLEASE ENSURE THAT ALL INSTRUCTIONS ARE UNDERSTOOD PRIOR TO FITMENT

PLACE THESE INSTRUCTIONS IN THE VEHICLES'S GLOVEBOX AFTER INSTALLATION IS COMPLETED

13. Torque all fasteners as specified on page2 of this document.

DO NOT OVER TIGHTEN AS MAY CAUSE DAMAGE TO ASSEMBLY.

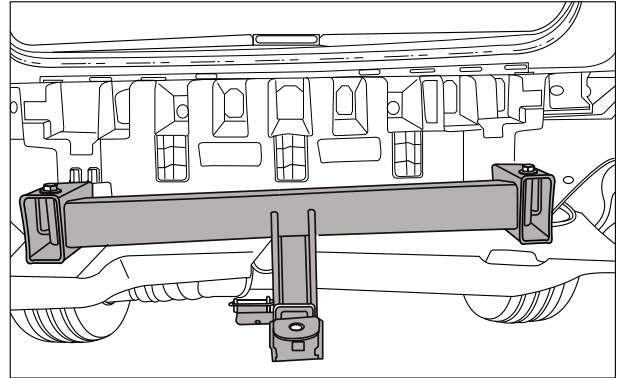

14. Secure the support brackets to the ad blue reservoir and exhaust shield using the M12X45 fasteners supplied.

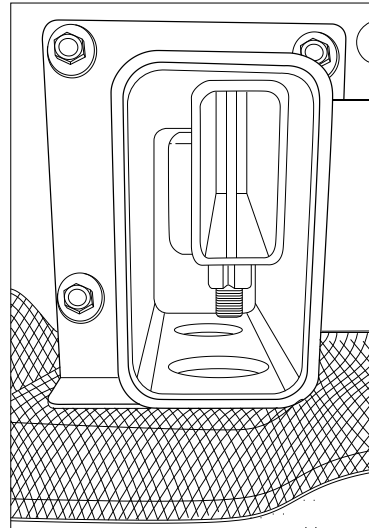

15. Cut 92mm wide and 85mm high from the bottom centre of the bumper bar to allow for protrusion of hitch and hitch receiver.

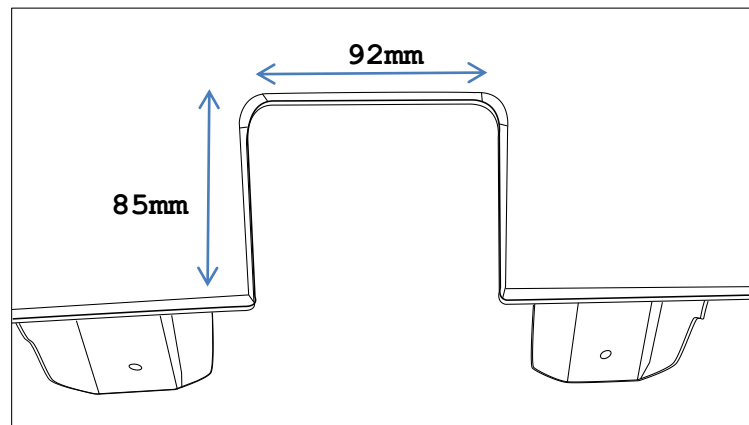

HAYMAN REESE

PART No: 101177-WL

MERCEDES GL X166

INSTALLATION INSTRUCTIONS

PLEASE ENSURE THAT INSTRUCTIONS ARE UNDERSTOOD PRIOR TO FITMENT

Wiring Loom Installation Instructions

MERCEDES GL X166

Part No: 101177-WL

ECU: 04826

Tail Harness Length Required: 1800mm

Wiring Loom Installation Time: Approx. 30 minutes

Issue Date 28/05/14

Page 1

Part No: 101177-WL

Hayman Reese (Cequent)

PO Box 4050, Dandenong South VIC 3164

Phone 1800 812 017 Email info@haymanreese.com.au

www.haymanreese.com.au



HAYMAN REESE
PART No: 101177-WL
MERCEDES GL X166

INSTALLATION INSTRUCTIONS

PLEASE ENSURE THAT INSTRUCTIONS ARE UNDERSTOOD PRIOR TO FITMENT

1. In the luggage compartment, remove the floor carpet cover (1).
2. Remove the luggage compartment rear trim (2).



3. Remove the RHS access panel cover (1)



4. Remove the LHS access panel cover (1).



Issue Date 28/05/14

Page 2

Part No: 101177-WL

Hayman Reese (Cequent)
PO Box 4050, Dandenong South VIC 3164
Phone 1800 812 017 Email info@haymanreese.com.au

HAYMAN REESE

PART No: 101177-WL
MERCEDES GL X166

INSTALLATION INSTRUCTIONS

PLEASE ENSURE THAT INSTRUCTIONS ARE UNDERSTOOD PRIOR TO FITMENT

5. Disconnect the RHS tail light connectors (1) and connect the trailer patch (P/No: 101177-WL) RHS branch connectors (2) in between.
6. Secure the trailer patch ground wire (3) to the vehicle grounding point (4).

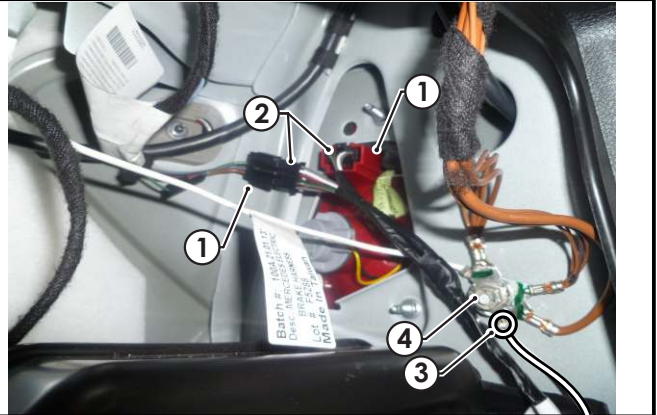

7. Secure the trailer patch power terminal (1) to the vehicle power lug (2).
8. Connect the trailer patch ECU connector (3) to the ECU (4).
9. Using the supplied cleaning pad, clean the vehicle sheet metal area (5) in a suitable location where the ECU (4) will be mounted. Ensure the ECU (4) is mounted with the connector pointing downwards.

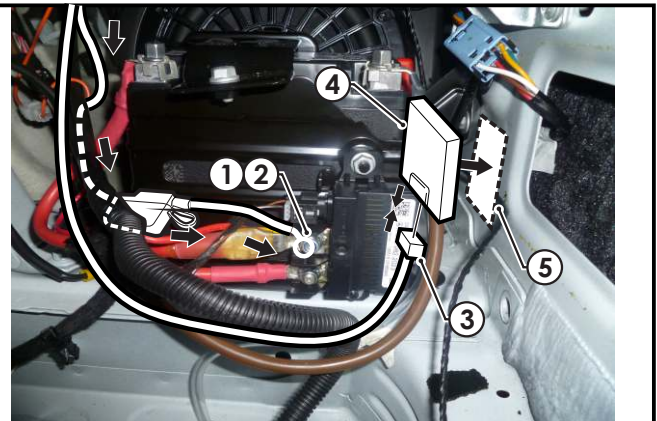

10. Locate the vehicle harness wiring loom (1).
11. Cut open the wiring loom (1) and locate the vehicle 'GREY/BLUE' reverse wire (2).
12. Following the table below, connect the ezy tap (3) to the harness terminal wire (2) and then connect the trailer harness terminal (4) to the corresponding wire (2)

Function	Trailer Patch	Vehicle Connector
REVERSE	BLACK / WHITE	GREY / BLUE

Use a multi-meter to confirm the correct wire before connecting.

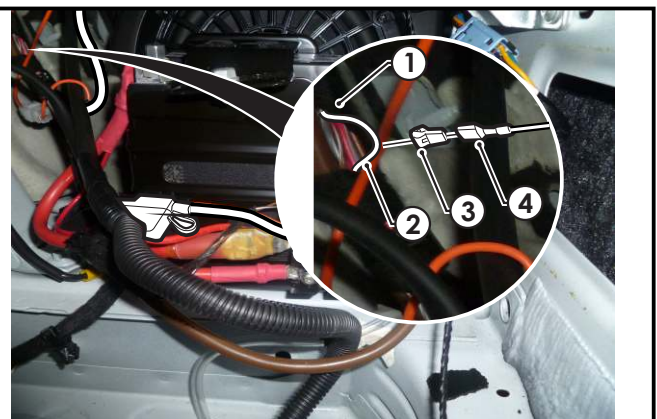

Issue Date 28/05/14

Page 3

Part No: 101177-WL

Hayman Reese (Cequent)
PO Box 4050, Dandenong South VIC 3164
Phone 1800 812 017 Email info@haymanreese.com.au

www.haymanreese.com.au



HAYMAN REESE
PART No: 101177-WL
MERCEDES GL X166

INSTALLATION INSTRUCTIONS

PLEASE ENSURE THAT INSTRUCTIONS ARE UNDERSTOOD PRIOR TO FITMENT

12. Route the trailer patch harness towards the LHS, and disconnect the LHS tail light connector (1).
13. Patch in the trailer harness (P/No: 101177-WL) mating connectors (2) in between.



14. Mount the trailer socket (1) to the tow bar mounting bracket using M4 fasteners (not supplied).
15. Route the tail harness (tail length 1800mm) (2) across the tow bar towards the RHS of the vehicle and up through the vehicle grommet hole (3).
16. Ensure the tail harness grommet is seated correctly and secured in place using a cable tie (not supplied).



17. Connect the trailer patch harness (1) to the tail harness (tail length 1800mm) (2).

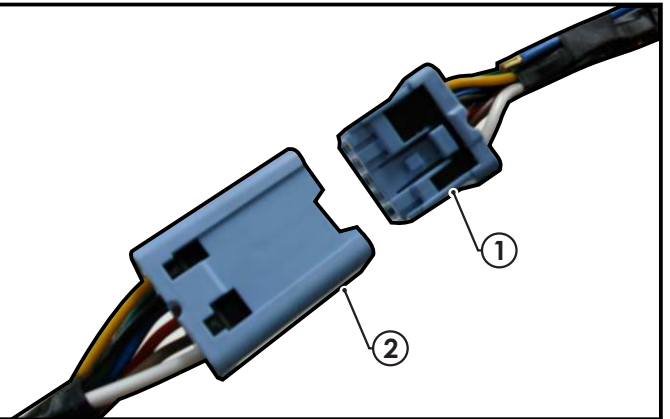

Issue Date 28/05/14

Page 4

Part No: 101177-WL

Hayman Reese (Cequent)
PO Box 4050, Dandenong South VIC 3164
Phone 1800 812 017 Email info@haymanreese.com.au

HAYMAN REESE

PART No: 101177-WL

MERCEDES GL X166

INSTALLATION INSTRUCTIONS

PLEASE ENSURE THAT INSTRUCTIONS ARE UNDERSTOOD PRIOR TO FITMENT

<p>16. Test the trailer harness function using a light board or multimeter.</p> <p>17. Secure all harnesses using cables ties (not supplied).</p> <p>18. Re-fit all removed parts and secure all fasteners, ensuring there are no squeaks or rattles.</p> <p>19. Place instructions in glove box after fitment.</p>	

Issue Date 28/05/14

Page 5

Part No: 101177-WL

Hayman Reese (Cequent)

PO Box 4050, Dandenong South VIC 3164

Phone 1800 812 017 Email info@haymanreese.com.au

www.haymanreese.com.au

