

HAYMAN REESE
PART No: 03076RW
JEEP CHEROKEE KL 06/14 ON

INSTALLATION INSTRUCTIONS

PLEASE ENSURE THAT ALL INSTRUCTIONS ARE UNDERSTOOD PRIOR TO FITMENT
PLACE THESE INSTRUCTIONS IN THE VEHICLE'S GLOVEBOX AFTER INSTALLATION IS COMPLETED



Installation Time: Approx **90** Mins

Towbar Installation Instructions

Towbar capacity

JEEP CHEROKEE KL 06/14 ON
NOT FOR TRAILHAWK VARIANTS

Part Number 03076RW	Max Towing Braked	2270 kg
	Max Towing Unbraked	450 kg
	Max Static Ball Load	227 kg

Hayman Reese (Cequent)
PO Box 4050, Dandenong South VIC 3164
Phone 1800 812 017 Email info@haymanreese.com.au

HAYMAN REESE

PART No: 03076RW

JEEP CHEROKEE KL 06/14 ON

INSTALLATION INSTRUCTIONS

PLEASE ENSURE THAT ALL INSTRUCTIONS ARE UNDERSTOOD PRIOR TO FITMENT
PLACE THESE INSTRUCTIONS IN THE VEHICLES'S GLOVEBOX AFTER INSTALLATION IS COMPLETED

Warning:

1. Do not, drill, cut, weld or otherwise modify the towbar.
2. If you are using electric welding on a motor vehicle, **always** check that the vehicle is not equipped with electronic engine or instrument management equipment. Failure to do so could **destroy** any onboard computers. If in doubt, check with the vehicle's manufacturer.
3. If TBM is used in inverted position tow ball may make contact with rear tailgate when lowered, which could cause damage.

General:

1. Ensure all hardware items have been included refer to assembly diagram.
2. It is recommended that the instructions are read through and completely understood before making any attempt to fit this product.
3. Be wary of any changes to vehicle designs or other accessories that may conflict with the installation of this product.
4. Before drilling ensure that the area is clear of fuel, electrical & other components.
5. All holes drilled into the body panels shall have all burrs & swarf removed then coated with a suitable rust preventative paint.
6. The high tensile fasteners supplied with this product were used to achieve the specified rating. If replacement is required ensure that fasteners of the same rating & quality are used. Contact an authorised **Hayman Reese** dealer if further information is required.
7. Ensure that all hardware is fastened to torque list below check fasteners on regular basis.
8. Towbar load rating sticker provided with this product shall be conspicuously located on inside rear end of the driver's door. **(See diagram below).**
9. Hayman Reese recommends that you check your tow ball to ensure that it complies with the Australian standards **AS 4177.2**.
10. **PLEASE NOTE:** It is advised to remove your lug or tbm when not actually towing so as to produce a clear view of the vehicles registration plate if obscured, and to also provide maximum available departure angle.
11. Pull Pin must be fit in down position.

Tow bar Maintenance and Care.

Hayman Reese recommends that bolt torque's, as listed below, are routinely and regularly inspected and checked for correct tension. Replace any worn or defective parts.

We recommended to remove Tow Ball Mounts (TBM's, tongues or lugs) when not being used for any considerable length of time.

So as to avoid injury, when not towing it is suggested that the tongue, Pull Pin and R-clip are removed then stored in a safe, clean and dry place, away from excessive moisture.

Hitch Pull Pins and spring "R" clips are regularly checked for proper installation. Replace any worn or defective parts.

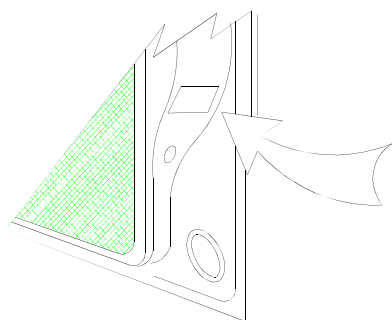

Place load rating sticker
inside driver's door here

RECOMMENDED ASSEMBLY TORQUE LISTING

Diameter Grade 8.8 Bolt

M6	9.5 Nm
M8	21.7 Nm
M10	43.4 Nm
M12	77.3 Nm
M14	146 Nm
M16	189.8 Nm

FOR TOWING PURPOSES ONLY

For towing capacity details please refer to vehicle owner's manual or to the manufacturer. Overloading can void your warranties.

HAYMAN REESE

PART No: 03076RW

JEEP CHEROKEE KL 06/14 ON

INSTALLATION INSTRUCTIONS

PLEASE ENSURE THAT ALL INSTRUCTIONS ARE UNDERSTOOD PRIOR TO FITMENT
PLACE THESE INSTRUCTIONS IN THE VEHICLES'S GLOVEBOX AFTER INSTALLATION IS COMPLETED

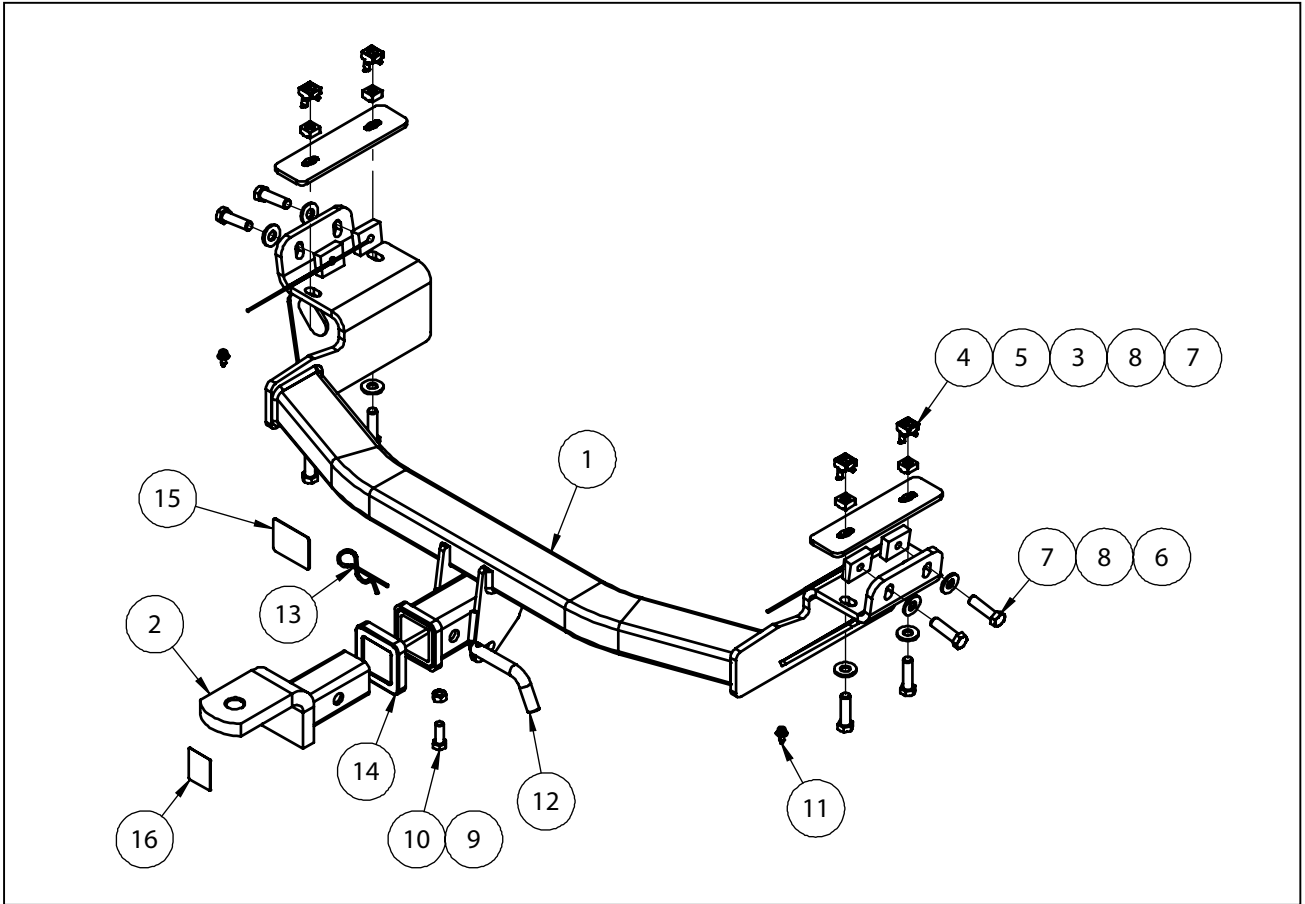

QTY	DESCRIPTION	ITEM NO
1	WELDED ASSY	1
1	TBM ASSY	2
2	PANEL PLATE	3
4	CAGE NUT RETAINER	4
4	CAGE NUT M12x1.75P	5
4	TAPPED PLATE & WIRE	6
8	BOLT M12x45 1.75P	7
8	WASHER FLAT M12	8
1	HEX NUT M10x1.5	9
1	SET SCREW HEX HD M10x30x1.5P	10
2	SCRIVET CFZ-020-0034	11
1	PULL PIN	12
1	SPRING COTTER PIN ASSY	13
1	HITCH BOX COLLAR COVER	14
1	ACRYLIC COMPLIANCE PLATE	15
1	H.R STICKER	16

ADDITIONAL ITEMS



WIRING LOOM



FITTING INSTRUCTION

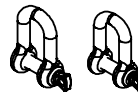

D SHACKLES



LR LABEL

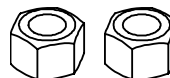

NUT NYLOC



PLUG BRACKET

INSTALLATION INSTRUCTIONS

PLEASE ENSURE THAT ALL INSTRUCTIONS ARE UNDERSTOOD PRIOR TO FITMENT

PLACE THESE INSTRUCTIONS IN THE VEHICLES'S GLOVEBOX AFTER INSTALLATION IS COMPLETED

1. Open boot lid and remove 2x torx Screws securing Left Hand side tail light to vehicle [1]. Remove tail light by carefully pulling rearwards. Disconnect wiring plug from light.

Repeat for opposite side of vehicle.

Remove torx Screw located in lower corner of rear hatch cavity [2].

Repeat for opposite side of vehicle.

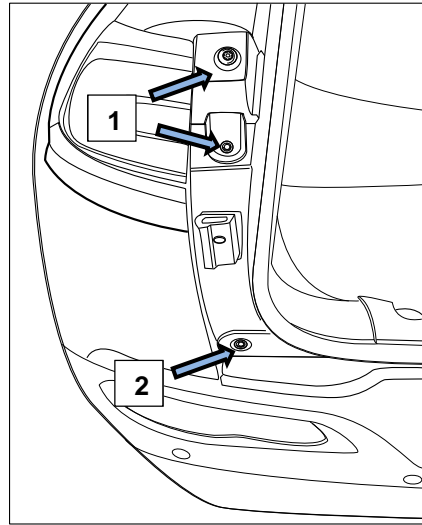

2. From underneath Rear Bumper, remove pop rivet located behind rear LH wheel.

Remove by drilling out rivets, repeat for opposite side of vehicle.

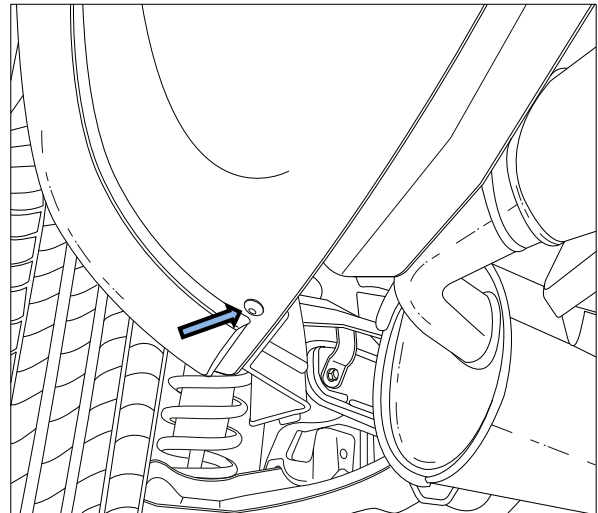

3. Remove 1x Hex Head Screw from the wheel well cavity, on the rearwards end.

Repeat for opposite side of vehicle.



INSTALLATION INSTRUCTIONS

PLEASE ENSURE THAT ALL INSTRUCTIONS ARE UNDERSTOOD PRIOR TO FITMENT

PLACE THESE INSTRUCTIONS IN THE VEHICLE'S GLOVEBOX AFTER INSTALLATION IS COMPLETED

4. From below centre of Chassis, remove 4x Head Screws securing trim to underside of chassis.

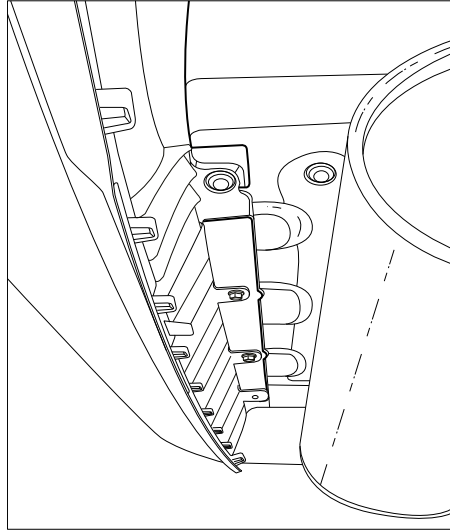

5. Using nose pliers or similar tool, remove wheel well outer trim, located above the well, from vehicle chassis.

Use pliers to clamp on small plastic plugs from the inside to loosen them from main vehicle body.

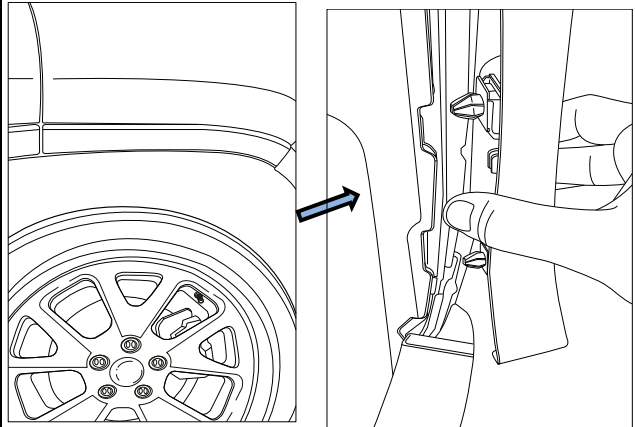

6. In newly exposed section, remove torx Screw securing rear vehicle Bumper to vehicle body.

Repeat steps 5 and 6 for opposite side of vehicle.

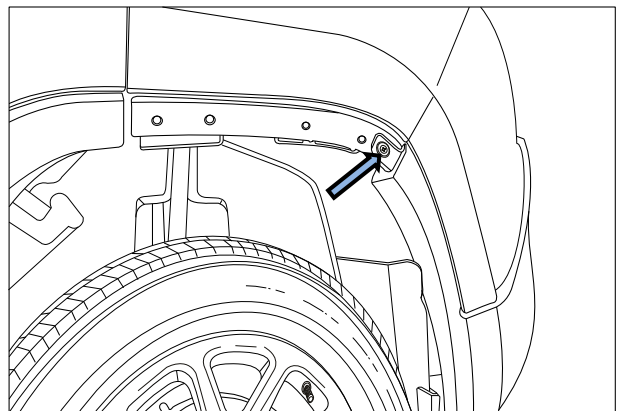

INSTALLATION INSTRUCTIONS

PLEASE ENSURE THAT ALL INSTRUCTIONS ARE UNDERSTOOD PRIOR TO FITMENT

PLACE THESE INSTRUCTIONS IN THE VEHICLES'S GLOVEBOX AFTER INSTALLATION IS COMPLETED

7. Carefully remove Bumper trim from vehicle, disconnecting any sensors mounted to Bumper trim.

Unmount rear impact beam from vehicle Chassis and store to side.

NOTE: On Trailhawk models of vehicle, towbar cannot be installed

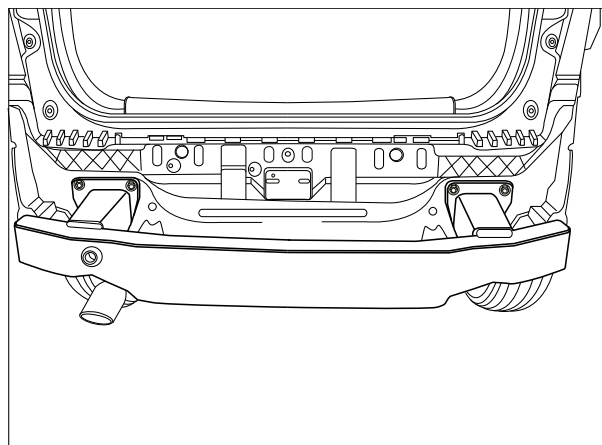

8. Remove rubber plug from vehicle Chassis Rails [1] and disconnect any brush plugs securing wiring harness to Chassis Rail [2].

Lower exhaust by removing 2x Bolts per side which secure hanger to chassis rails [3].

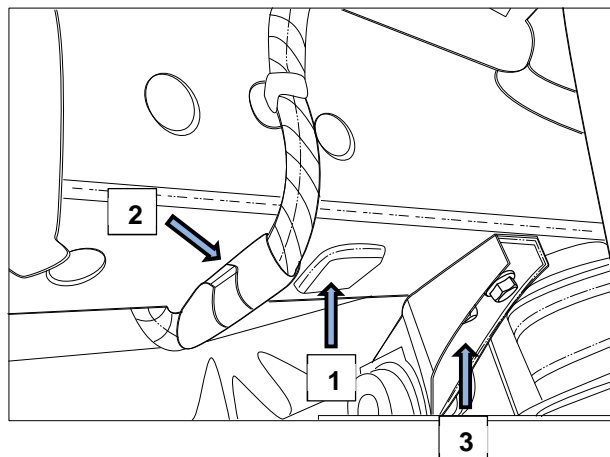

9. Insert Cage Nuts into lose plates. Ensure tabs on Nut align with slots in plate.

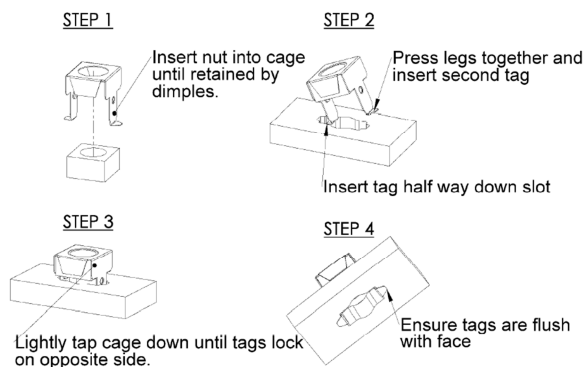

INSTALLATION INSTRUCTIONS

PLEASE ENSURE THAT ALL INSTRUCTIONS ARE UNDERSTOOD PRIOR TO FITMENT

PLACE THESE INSTRUCTIONS IN THE VEHICLE'S GLOVEBOX AFTER INSTALLATION IS COMPLETED

10. Insert plates with Cage Nuts mounted into Chassis Rail, aligning with holes in Chassis Rails.

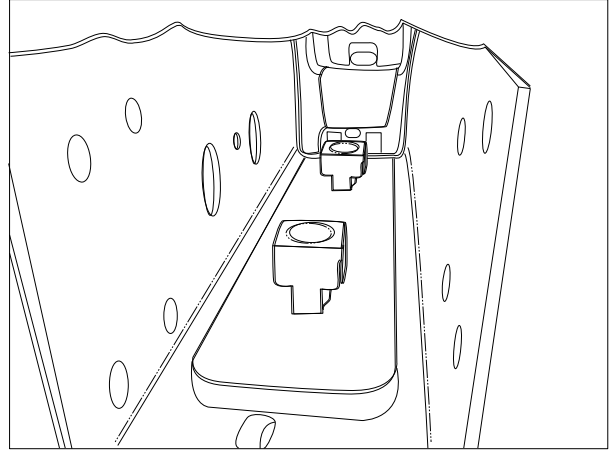

11. Mount Towbar to vehicle, mounting M12 Bolts vertically through the chassis rail to the inserted plate.
- Mount horizontal mount points by inserting tapped plates on wire into vehicle chassis rail.
- Remount impact beam to vehicle.

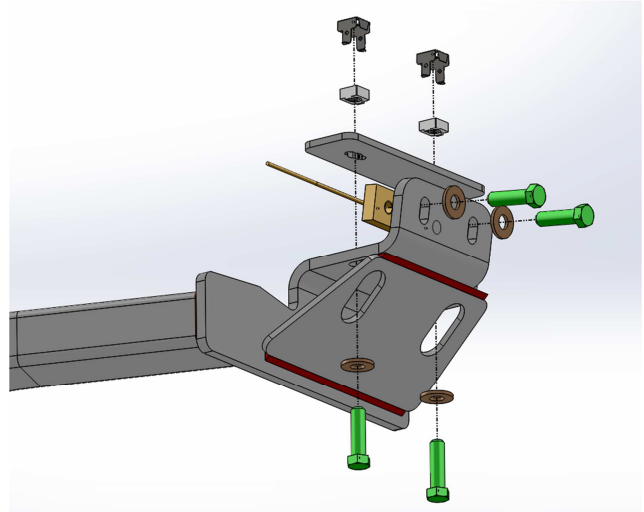

12. Referring to the template on page 9; make a cut in the bumper facia to allow for fitment of the towbar through the rear Bumper.

Align upper edge of cut with corner of bumper located above indentation on bumper trim

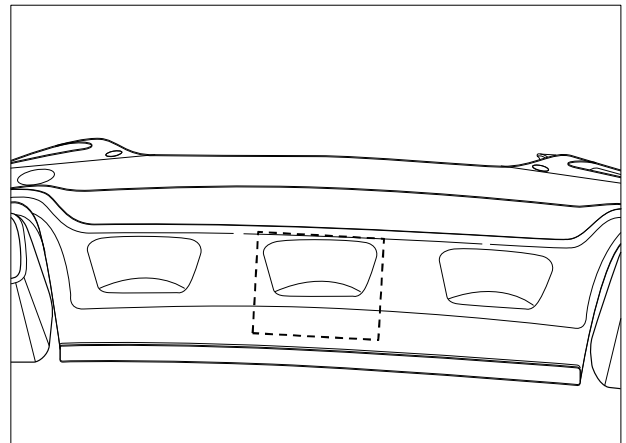

HAYMAN REESE

PART No: **03076RW**

JEEP CHEROKEE KL 06/14 ON

INSTALLATION INSTRUCTIONS

PLEASE ENSURE THAT ALL INSTRUCTIONS ARE UNDERSTOOD PRIOR TO FITMENT

PLACE THESE INSTRUCTIONS IN THE VEHICLES'S GLOVEBOX AFTER INSTALLATION IS COMPLETED

13. Remount exhaust hangers to vehicle.

14. Remount bumper assembly to vehicle following steps 1 to 7 in reverse.

Replace removed pop rivets in step 2 with scrivets supplied in kit.

INSTALLATION INSTRUCTIONS

PLEASE ENSURE THAT ALL INSTRUCTIONS ARE UNDERSTOOD PRIOR TO FITMENT
PLACE THESE INSTRUCTIONS IN THE VEHICLE'S GLOVEBOX AFTER INSTALLATION IS COMPLETED

BUMPER CUT TEMPLATE JEEP CHEROKEE KL

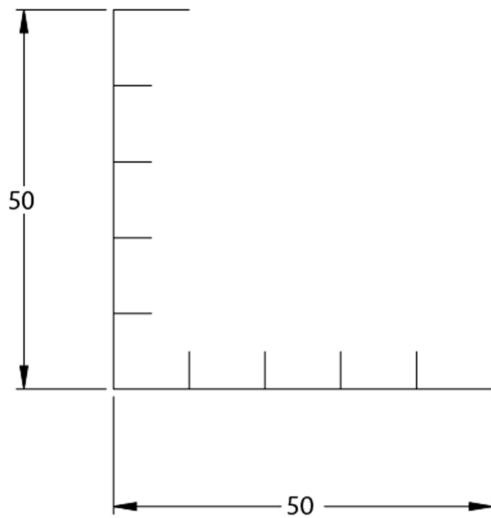

CUTTING INSTRUCTIONS:

1. BEFORE PROCEEDING, ENSURE SCALE IS CORRECT BY USING SCALE PROVIDED ABOVE
2. MARK CENTRELINE OF VEHICLE BUMPER AND ALIGN WITH CENTRELINE OF CUT TEMPLATE. ENSURE TEMPLATE ADHERES TO PROFILE OF BUMPER
3. DRILL 4X 12MM HOLES AT EACH CORNER OF TEMPLATE
4. USING A JIGSAW CUTTER OR SIMILAR TOOL, CUT ALONG TEMPLATE PROFILE
5. USE A FILE OR SIMILAR TOOL TO REMOVE EXCESS BURRS

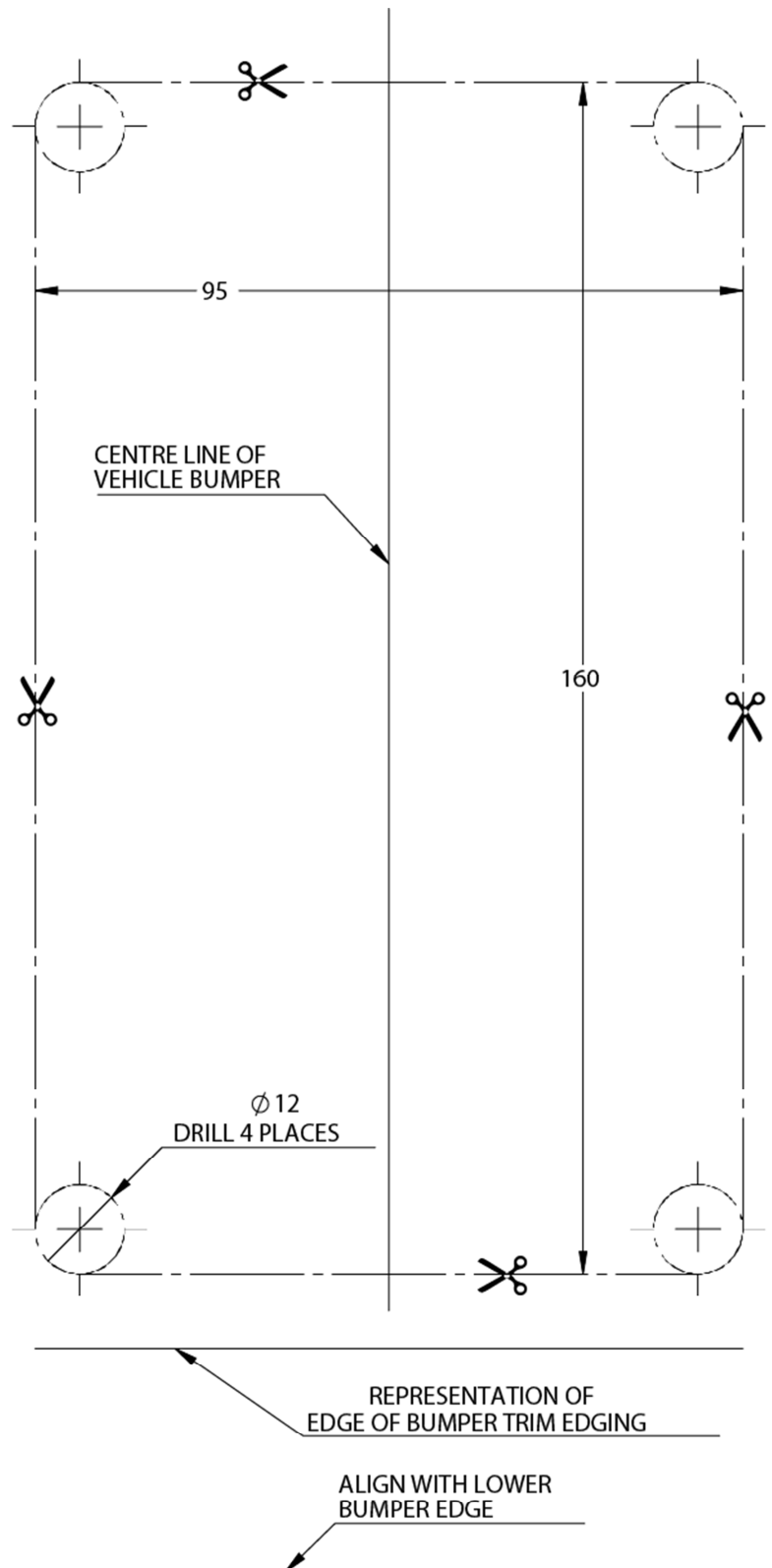

HAYMAN REESE
PART No: 101201-WL
JEEP CHEROKEE KL MY14

INSTALLATION INSTRUCTIONS

PLEASE ENSURE THAT INSTRUCTIONS ARE UNDERSTOOD PRIOR TO FITMENT

Wiring Loom Installation Instructions

JEEP CHEROKEE KL MY14

Part No: 101201-WL

Tail Harness Length Required: 1800mm
ECU - 04826

Wiring Loom Installation Time: Approx. 45 minutes

Issue Date 24-07-14

Page 1

Part No: 101201-WL

Hayman Reese (Cequent)
PO Box 4050, Dandenong South VIC 3164
Phone 1800 812 017 Email info@haymanreese.com.au

www.haymanreese.com.au



HAYMAN REESE
PART No: 101201-WL
JEEP CHEROKEE KL MY14

INSTALLATION INSTRUCTIONS

PLEASE ENSURE THAT INSTRUCTIONS ARE UNDERSTOOD PRIOR TO FITMENT

1. In the luggage compartment area, fold down the rear seats (1) and remove the rear trim (2), floor carpet (3) and the LHS and RHS rear quarter trims (4).

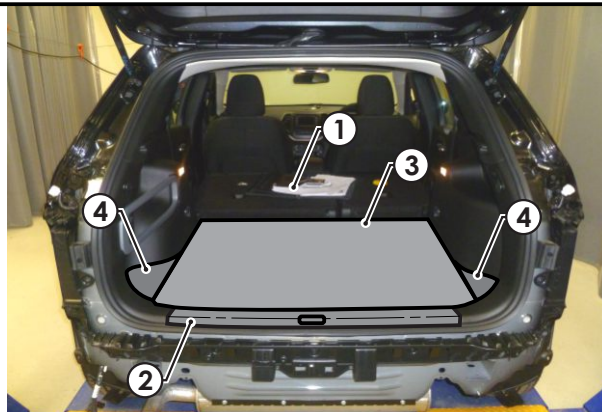

2. On the LHS trim, twist the fastener (1) 90 degrees and then remove the holder (2).
3. Open the clip (3) and remove the screw from underneath. Dislodge the LHS trim (4).
4. **Repeat for the RHS (with the exception of the holder).**

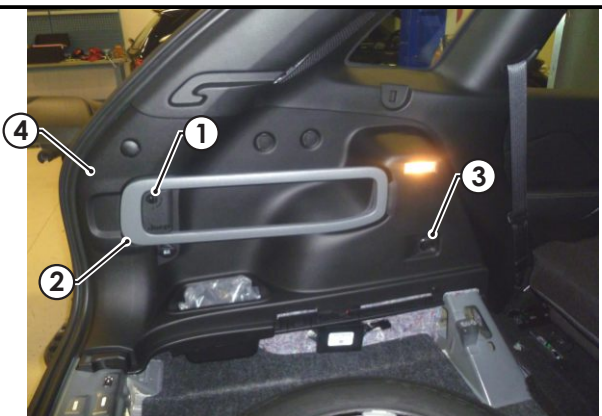

5. At the rear RHS quarter, drill out the smaller grommet (1) to Ø30mm. If the grommet is occupied, drill a Ø30mm hole into a suitable location nearby (2).
6. Apply rust inhibitor after drilling.



Issue Date 24-07-14

Page 2

Part No: 101201-WL

Hayman Reese (Cequent)
PO Box 4050, Dandenong South VIC 3164
Phone 1800 812 017 Email info@haymanreese.com.au

www.haymanreese.com.au



HAYMAN REESE
PART No: 101201-WL
JEEP CHEROKEE KL MY14

INSTALLATION INSTRUCTIONS

PLEASE ENSURE THAT INSTRUCTIONS ARE UNDERSTOOD PRIOR TO FITMENT

7. At the rear RHS passenger cabin, completely dislodge the 'B' pillar trim lower section (1).
8. Remove the rear RHS door sill trim (2).

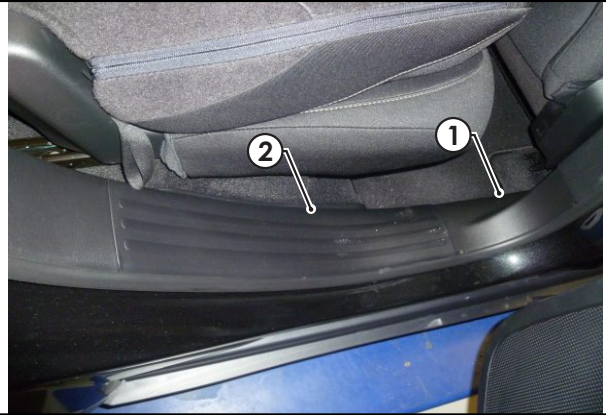

9. Remove the front RHS door sill trim/kick trim (1)



10. Remove the driver's fuse access panel (1).



Issue Date 24-07-14

Page 3

Part No: 101201-WL

Hayman Reese (Cequent)
PO Box 4050, Dandenong South VIC 3164
Phone 1800 812 017 Email info@haymanreese.com.au

www.haymanreese.com.au



HAYMAN REESE
PART No: 101201-WL
JEEP CHEROKEE KL MY14

INSTALLATION INSTRUCTIONS

PLEASE ENSURE THAT INSTRUCTIONS ARE UNDERSTOOD PRIOR TO FITMENT

11. Disconnect the LHS tail lamp connector (1) and retrieve the connector and grommet into the vehicle.
12. Connect the trailer patch (P/No: 101201-WL) LHS branch male connector (2) to the vehicle female connector (1). Connect the trailer patch LHS branch female connector (3) to the tail lamp assembly and secure the trailer patch grommet into place.
13. Route the trailer patch harness along the rear of the vehicle and towards the RHS tail lamp area.

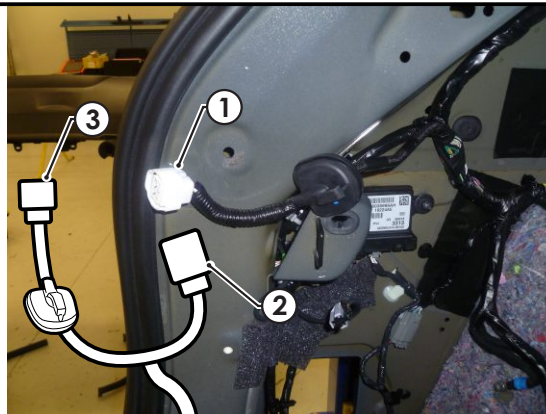

14. Disconnect the RHS tail lamp connector and retrieve the connector and grommet into the vehicle.
15. Connect the trailer patch RHS branch male connector (1) to the vehicle female connector. Connect the trailer patch RHS branch female connector (2) to the tail lamp assembly and secure the trailer patch grommet into place.
16. Secure the trailer patch ground ring terminal (3) to the vehicle grounding point (4).

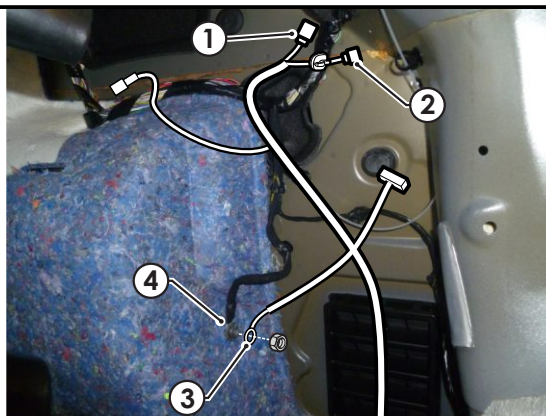

17. Connect the trailer patch ECU connector (1) to the ECU (P/No: 04826) (2).
18. Remove the adhesive backing from the ECU (2) and secure the ECU (2) onto the vehicle sheet metal area where appropriate (3). **Ensure the ECU is secured with the connector pointing downwards.**
19. Route the trailer patch harness 1-way connector (4) along the RHS vehicle harness towards the driver's fuse panel area.

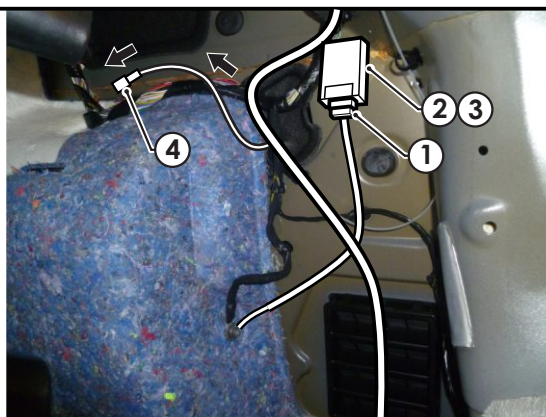

Issue Date 24-07-14

Page 4

Part No: 101201-WL

Hayman Reese (Cequent)
PO Box 4050, Dandenong South VIC 3164
Phone 1800 812 017 Email info@haymanreese.com.au

www.haymanreese.com.au



HAYMAN REESE
PART No: 101201-WL
JEEP CHEROKEE KL MY14

INSTALLATION INSTRUCTIONS

PLEASE ENSURE THAT INSTRUCTIONS ARE UNDERSTOOD PRIOR TO FITMENT

20. At the driver's fuse panel area, insert the supplied fuse (20A) (1) into the add-a-fuse harness (2) upper slot.

21. Connect the add-a-fuse harness 1-way connector (2) to the trailer patch 1-way connector (3).

22. Insert the add-a-fuse (4) into the empty fuse location (5).

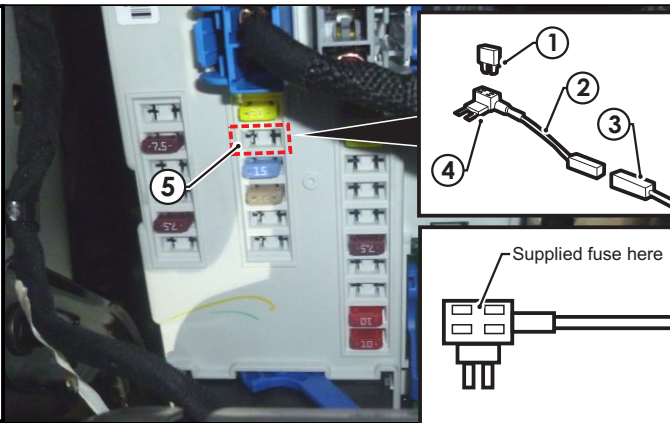

23. At the rear exterior of the vehicle, mount the tail harness socket (1) to the towbar mounting bracket using M4 fasteners (not supplied).

24. Route the tail harness (tail length: 1800mm) (2) across the RHS and up into the drilled out hole (3). Adjust the trailer patch harness grommet so that it is seated correctly and cable tie (not supplied) in place.



25. Connect the tail harness 8-way connector (1) to the trailer patch 8-way mating connector (2).

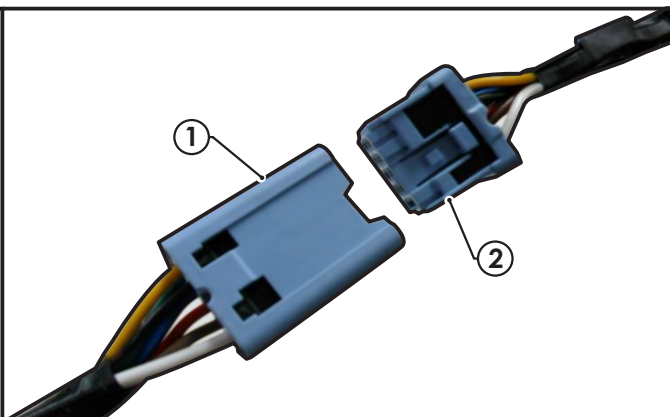

Issue Date 24-07-14

Page 5

Part No: 101201-WL

Hayman Reese (Cequent)
PO Box 4050, Dandenong South VIC 3164
Phone 1800 812 017 Email info@haymanreese.com.au

www.haymanreese.com.au



HAYMAN REESE
PART No: 101201-WL
JEEP CHEROKEE KL MY14

PLEASE ENSURE THAT INSTRUCTIONS ARE UNDERSTOOD PRIOR TO FITMENT

- | | |
|--|--|
| <p>26. Test the Trailer Harness function using a Light Board or multimeter.</p> <p>27. Secure all harnesses using cable ties (not supplied).</p> <p>28. Re-fit all removed parts and secure all fasteners, ensure there are no squeaks or rattles.</p> <p>29. Place instructions in glove box after fitment.</p> | |
|--|--|

Issue Date 24-07-14

Part No: 101201-WL

Hayman Reese (Cequent)
PO Box 4050, Dandenong South VIC 3164
Phone 1800 812 017 Email info@haymanreese.com.au

www.haymanreese.com.au

