

**HAYMAN REESE**  
**PART No: 03112RW-FI**  
**HOLDEN CAPTIVA 7CG SERIES**  
**INSTALLATION INSTRUCTIONS**

PLEASE ENSURE THAT ALL INSTRUCTIONS ARE UNDERSTOOD PRIOR TO FITMENT  
PLACE THESE INSTRUCTIONS IN THE VEHICLE'S GLOVEBOX AFTER INSTALLATION IS COMPLETED



**Installation Time: Approx 90 Mins**

**Towbar Installation Instructions**

**Towbar capacity**

**HOLDEN CAPTIVA 7 CG SERIES**

<b>Part Number 03112RW</b>	<b>Max Towing Braked</b>	<b>2000 kg</b>
	<b>Max Towing Unbraked</b>	<b>750 kg</b>
	<b>Max Static Ball Load</b>	<b>158 kg</b>

Hayman Reese (Cequent)  
PO Box 4050, Dandenong South VIC 3164  
Phone 1800 812 017 Email [info@haymanreese.com.au](mailto:info@haymanreese.com.au)

**HAYMAN REESE**  
**PART No: 03112RW-FI**  
**HOLDEN CAPTIVA 7 CG SERIES**

**INSTALLATION INSTRUCTIONS**

PLEASE ENSURE THAT ALL INSTRUCTIONS ARE UNDERSTOOD PRIOR TO FITMENT  
PLACE THESE INSTRUCTIONS IN THE VEHICLES'S GLOVEBOX AFTER INSTALLATION IS COMPLETED

**Warning:**

1. Do not, drill, cut, weld or otherwise modify the towbar.
2. If you are using electric welding on a motor vehicle, **always** check that the vehicle is not equipped with electronic engine or instrument management equipment. Failure to do so could **destroy** any onboard computers. If in doubt, check with the vehicle's manufacturer.
3. If TBM is used in inverted position tow ball may make contact with rear tailgate when lowered, which could cause damage.

**General:**

1. Ensure all hardware items have been included refer to assembly diagram.
2. It is recommended that the instructions are read through and completely understood before making any attempt to fit this product.
3. Be wary of any changes to vehicle designs or other accessories that may conflict with the installation of this product.
4. Before drilling ensure that the area is clear of fuel, electrical & other components.
5. All holes drilled into the body panels shall have all burrs & swarf removed then coated with a suitable rust preventative paint.
6. The high tensile fasteners supplied with this product were used to achieve the specified rating. If replacement is required ensure that fasteners of the same rating & quality are used. Contact an authorised **Hayman Reese** dealer if further information is required.
7. Ensure that all hardware is fastened to torque list below check fasteners on regular basis.
8. Towbar load rating sticker provided with this product shall be conspicuously located on inside rear end of the driver's door. **(See diagram below).**
9. Hayman Reese recommends that you check your tow ball to ensure that it complies with the Australian standards **AS 4177.2**.
10. **PLEASE NOTE:** It is advised to remove your lug or tbn when not actually towing so as to produce a clear view of the vehicles registration plate if obscured, and to also provide maximum available departure angle.
11. Pull Pin must be fit in down position.

**Tow bar Maintenance and Care.**

Hayman Reese recommends that bolt torque's, as listed below, are routinely and regularly inspected and checked for correct tension. Replace any worn or defective parts.

We recommended to remove Tow Ball Mounts (TBM's, tongues or lugs) when not being used for any considerable length of time.

So as to avoid injury, when not towing it is suggested that the tongue, Pull Pin and R-clip are removed then stored in a safe, clean and dry place, away from excessive moisture.

Hitch Pull Pins and spring "R" clips are regularly checked for proper installation. Replace any worn or defective parts.

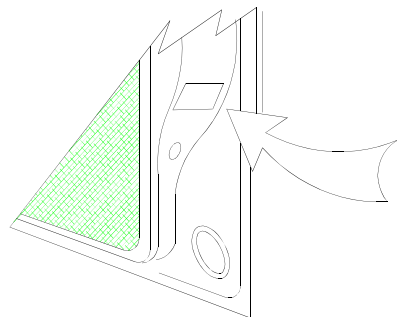

**Place load rating sticker  
inside driver's door here**

**RECOMMENDED ASSEMBLY TORQUE  
LISTING**

**Diameter Grade 8.8 Bolt**

M6	9.5 Nm
M8	21.7 Nm
M10	43.4 Nm
M12	77.3 Nm
M14	146 Nm
M16	189.8 Nm

**FOR TOWING PURPOSES ONLY**

**For towing capacity details please refer to vehicle  
owner's manual or to the manufacturer. Overloading can  
void your warranties.**

**HAYMAN REESE**  
**PART No: 03112RW-FI**  
**HOLDEN CAPTIVA 7 CG SERIES**  
**INSTALLATION INSTRUCTIONS**

PLEASE ENSURE THAT ALL INSTRUCTIONS ARE UNDERSTOOD PRIOR TO FITMENT  
 PLACE THESE INSTRUCTIONS IN THE VEHICLES'S GLOVEBOX AFTER INSTALLATION IS COMPLETED

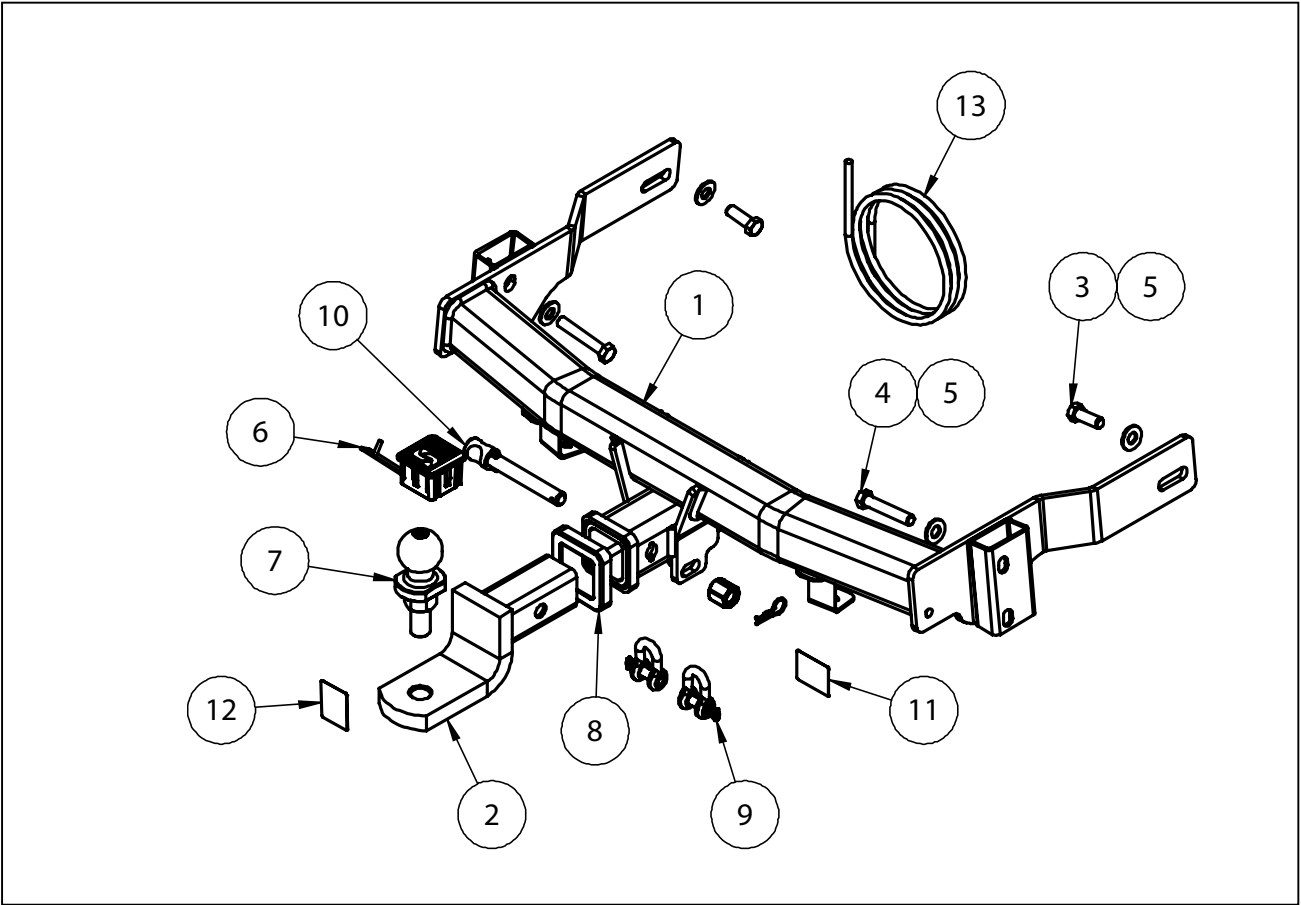

QTY.	DESCRIPTION	ITEM NO.
1	WELDED ASSY	1
1	TBM ASSY	2
2	SET SCREW M12x35 1.75P	3
4	BOLT M12x70x1.75P	4
6	WASHER FLAT M12	5
1	PLUG BRACKET	6
1	HR TOWBALL	7
1	HITCH BOX COLLAR COVER	8
2	10mm "D" SHACKLE	9
1	ANTI-RATTLE PULL PIN ASSY GOLD	10
1	HR ADR LABEL	11
1	H.R STICKER	12
1	WIRING LOOM	13

**HAYMAN REESE**  
**PART No: 03112RW-FI**  
**HOLDEN CAPTIVA 7 CG SERIES**  
**INSTALLATION INSTRUCTIONS**

PLEASE ENSURE THAT ALL INSTRUCTIONS ARE UNDERSTOOD PRIOR TO FITMENT  
PLACE THESE INSTRUCTIONS IN THE VEHICLES'S GLOVEBOX AFTER INSTALLATION IS COMPLETED

1. Open the vehicle tail gate.

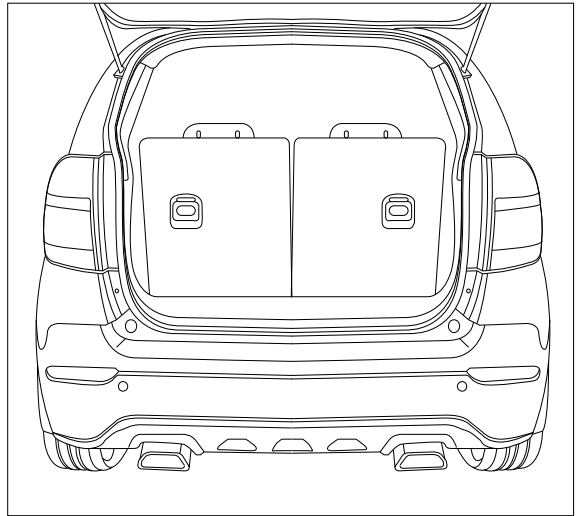

2. Remove 2 Screws on the RHS tail light located under the plastic covers.  
  
Repeat for LHS.

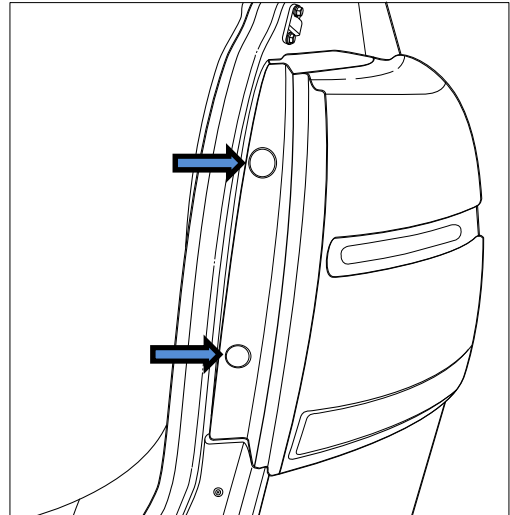

3. Dislodge the RHS tail light and set aside.  
  
Repeat for LHS.

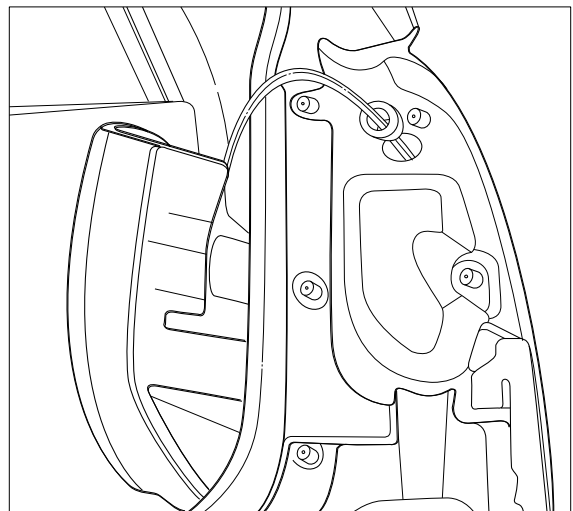

**HAYMAN REESE**  
PART No: 03112RW-FI  
HOLDEN CAPTIVA 7 CG SERIES

**INSTALLATION INSTRUCTIONS**

PLEASE ENSURE THAT ALL INSTRUCTIONS ARE UNDERSTOOD PRIOR TO FITMENT  
PLACE THESE INSTRUCTIONS IN THE VEHICLES'S GLOVEBOX AFTER INSTALLATION IS COMPLETED

4. Remove 3 Screws on the RHS of the bumper.

Repeat for LHS.

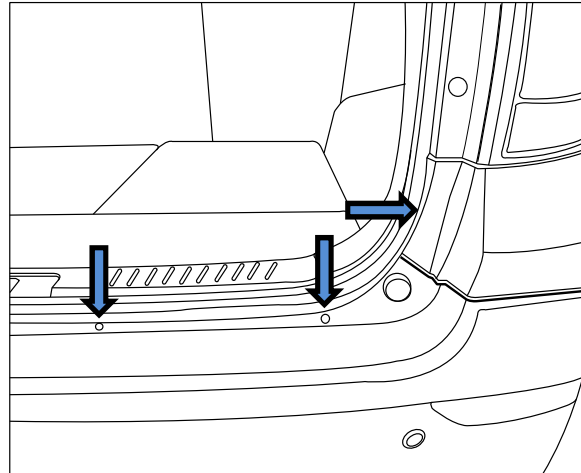

5. Remove 3 Screws on the inside RHS of the mud flap and wheel arch.

Repeat for LHS.

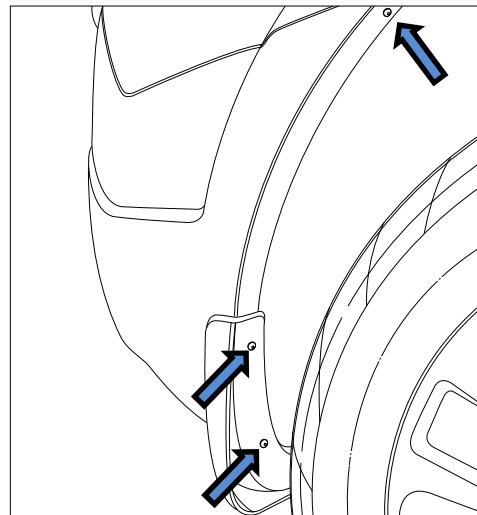

6. Remove 2 Scrivets and 1 Screw from the underside of the bumper on the RHS.

Repeat for LHS.

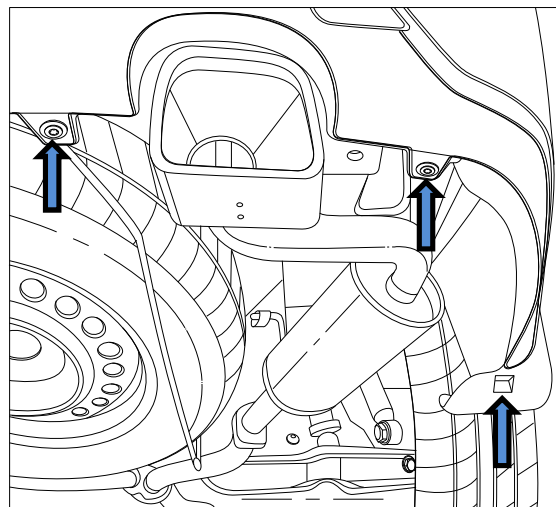

**HAYMAN REESE**  
PART No: 03112RW-FI  
HOLDEN CAPTIVA 7 CG SERIES

**INSTALLATION INSTRUCTIONS**

PLEASE ENSURE THAT ALL INSTRUCTIONS ARE UNDERSTOOD PRIOR TO FITMENT  
PLACE THESE INSTRUCTIONS IN THE VEHICLES'S GLOVEBOX AFTER INSTALLATION IS COMPLETED

7. Unclip the bumper and set aside.

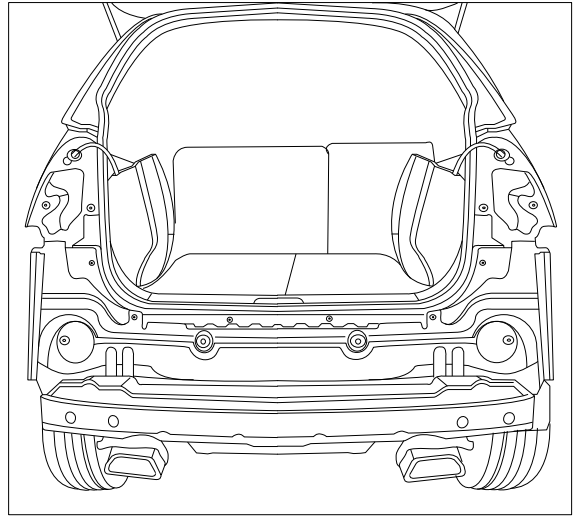

8. Remove 3 Bolts from the RHS of the intrusion beam.  
Repeat for LHS.

Repeat for LHS.

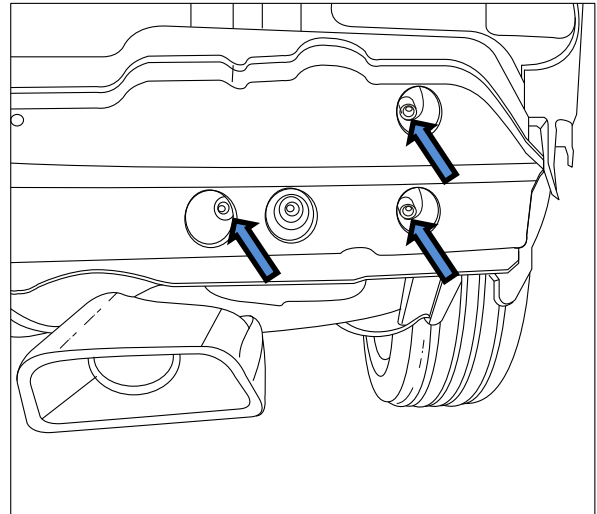

9. Remove intrusion beam and discard.

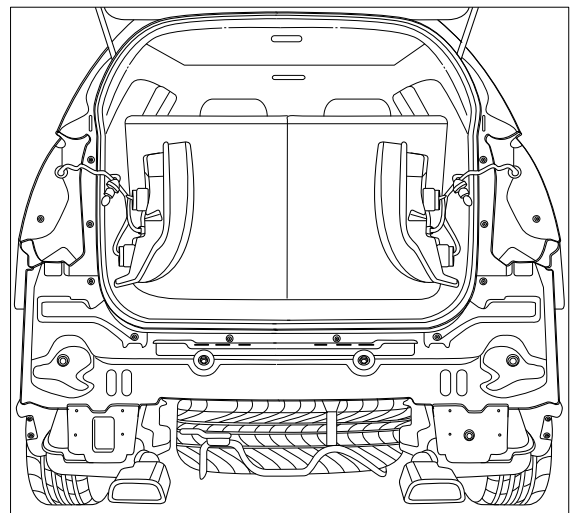

**HAYMAN REESE**  
**PART No: 03112RW-FI**  
**HOLDEN CAPTIVA 7 CG SERIES**  
**INSTALLATION INSTRUCTIONS**

PLEASE ENSURE THAT ALL INSTRUCTIONS ARE UNDERSTOOD PRIOR TO FITMENT  
PLACE THESE INSTRUCTIONS IN THE VEHICLES'S GLOVEBOX AFTER INSTALLATION IS COMPLETED

10. Drop the RHS exhaust hanger.

Repeat for LHS.

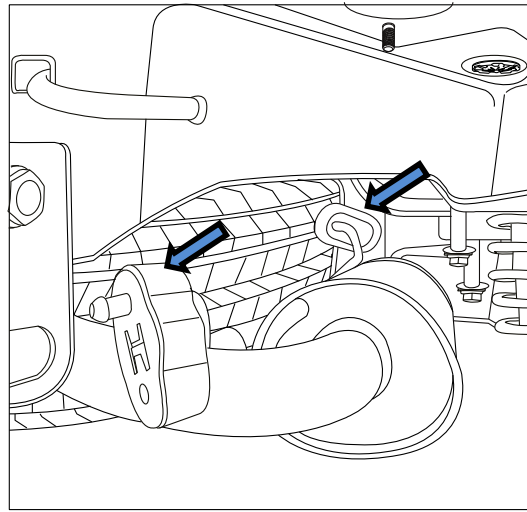

11. Offer the Towbar to the vehicle mounting via 3 Bolts per side.

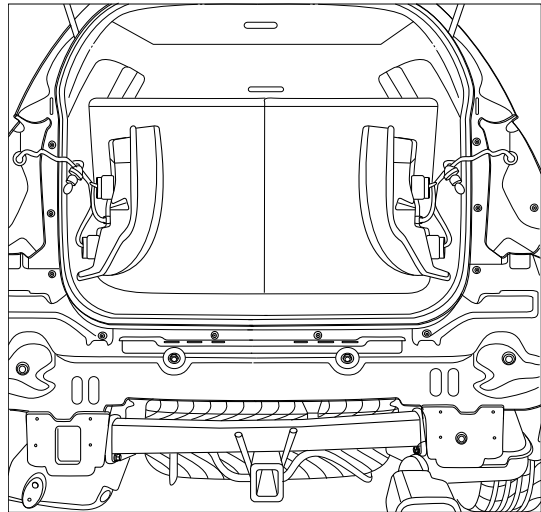

12. Torque all bolts to required specifications as listed on page 2.

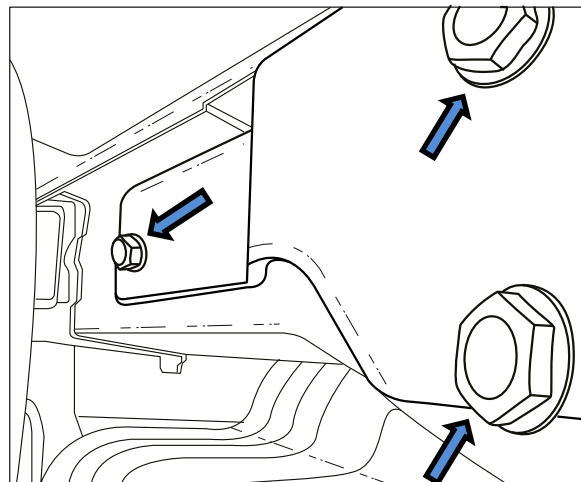

**HAYMAN REESE**  
PART No: 03112RW-FI  
HOLDEN CAPTIVA 7 CG SERIES

**INSTALLATION INSTRUCTIONS**

PLEASE ENSURE THAT ALL INSTRUCTIONS ARE UNDERSTOOD PRIOR TO FITMENT  
PLACE THESE INSTRUCTIONS IN THE VEHICLES'S GLOVEBOX AFTER INSTALLATION IS COMPLETED

13. Perform a bumper cut:

- Pre MY14, establish the centre line of the bumper and measure 45mm from centre line each side. Measure 110mm from bottom edge of bumper as shown in the image on the left, and cut out using a Stanley knife or air saw.
- MY14 onwards as per the template on page 10.

**PRE MY14**

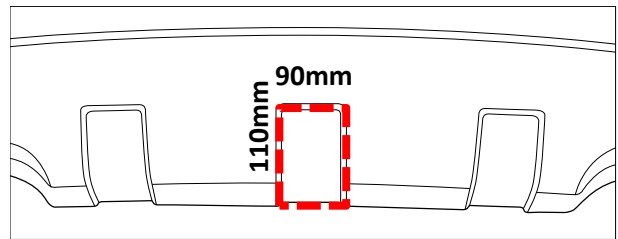

**MY14 ONWARDS**

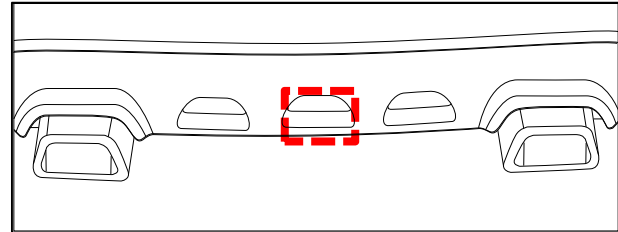

14. Refit bumper and tail lights to the vehicle.



**HAYMAN REESE**  
**PART No: 03112RW-FI**  
**HOLDEN CAPTIVA 7 CG SERIES**  
**INSTALLATION INSTRUCTIONS**

PLEASE ENSURE THAT ALL INSTRUCTIONS ARE UNDERSTOOD PRIOR TO FITMENT  
PLACE THESE INSTRUCTIONS IN THE VEHICLES'S GLOVEBOX AFTER INSTALLATION IS COMPLETED

**THIS PAGE HAS BEEN LEFT INTENTIONALLY BLANK**

**HAYMAN REESE**  
PART No: 03112RW-FI  
HOLDEN CAPTIVA 7 CG SERIES  
**INSTALLATION INSTRUCTIONS**

PLEASE ENSURE THAT ALL INSTRUCTIONS ARE UNDERSTOOD PRIOR TO FITMENT  
PLACE THESE INSTRUCTIONS IN THE VEHICLES'S GLOVEBOX AFTER INSTALLATION IS COMPLETED

MY14 ONWARDS

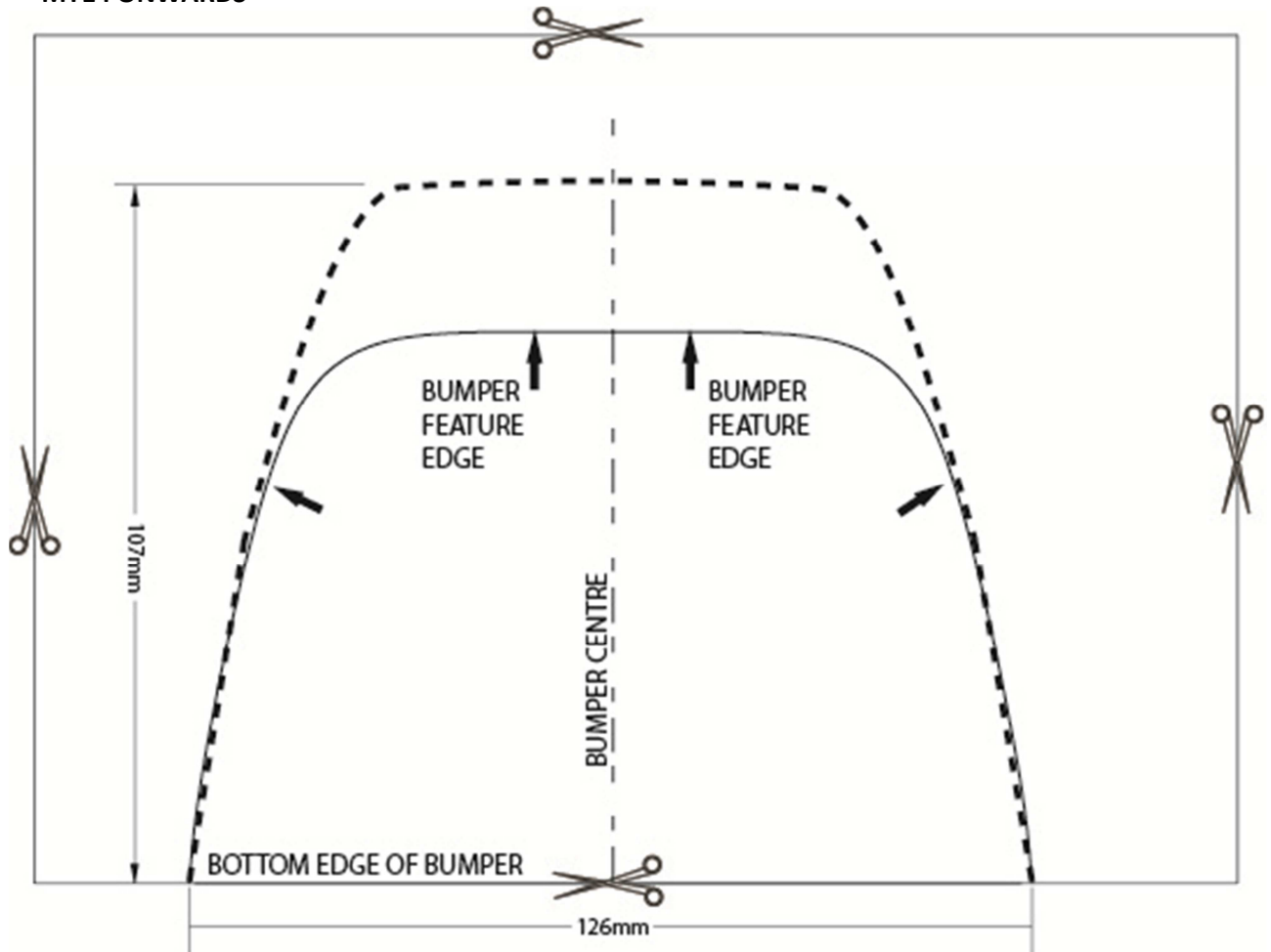

1. Check all dimensions are to scale.
2. Locate the centre of the rear bumper.
3. Cut out the bumper template and align with the centre of the bumper & bumper features.
4. Using a stanley knife or air saw, cut along the dotted lines.

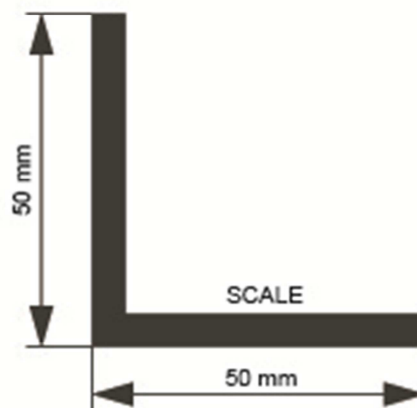

**HAYMAN REESE**  
**HOLDEN CAPTIVA**  
**PART No: 100405-WL**

## **INSTALLATION INSTRUCTIONS**

PLEASE ENSURE THAT INSTRUCTIONS ARE UNDERSTOOD PRIOR TO FITMENT

### **Wiring Loom Installation Instructions**

**HOLDEN CAPTIVA**  
**Part No: 100405-WL**  
**ECU: 04830**

**Tail Harness Length Required: 1200mm**  
**RPA Override Switch Part No: 04848 (If Fitted)**

**Wiring Loom Installation Time: Approx 20 Mins**

Issue Date 07-07-10

Page 1

Part No: 100405-WL

Hayman Reese (Cequent)  
PO Box 4050, Dandenong South VIC 3164  
Phone 1800 812 017 Email [info@haymanreese.com.au](mailto:info@haymanreese.com.au)

[www.haymanreese.com.au](http://www.haymanreese.com.au)



**HAYMAN REESE  
HOLDEN CAPTIVA  
PART No: 100405-WL**

# INSTALLATION INSTRUCTIONS

**PLEASE ENSURE THAT INSTRUCTIONS ARE UNDERSTOOD PRIOR TO FITMENT**

1. In the luggage compartment, remove the RHS storage compartment cover (1).



2. Remove the RHS storage compartment (1) by removing the fastener on the bottom.

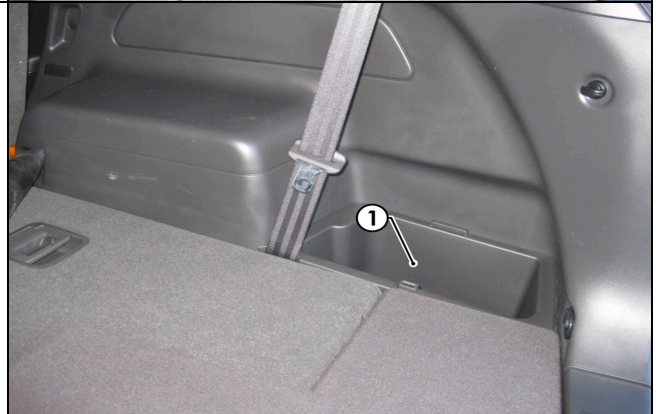

3. Locate the RHS 16-way breakout connector (1).



Issue Date 07-07-10

Page 2

Part No: 100405-WL

Hayman Reese (Cequent)  
PO Box 4050, Dandenong South VIC 3164  
Phone 1800 812 017 Email [info@haymanreese.com.au](mailto:info@haymanreese.com.au)

[www.haymanreese.com.au](http://www.haymanreese.com.au)



**HAYMAN REESE**  
**HOLDEN CAPTIVA**  
**PART No: 100405-WL**

**INSTALLATION INSTRUCTIONS**

**PLEASE ENSURE THAT INSTRUCTIONS ARE UNDERSTOOD PRIOR TO FITMENT**

4. Drill a Ø31mm hole (1) into the area next to the vehicle grommet. File down any rough or sharp edges and then spray on rust inhibitor.
5. Mount the tail harness socket (tail length 1200mm) to the towbar mounting bracket using M4 fasteners (not supplied).



6. Route the tail harness connector into the drilled out hole (1). Adjust the tail harness grommet into place ensuring it is seated correctly. Secure the tail harness grommet into place using a cable tie (not supplied).
7. Connect the Trailer Harness (P/No:100405-WL) 16-way connector (1) to the breakout connector.

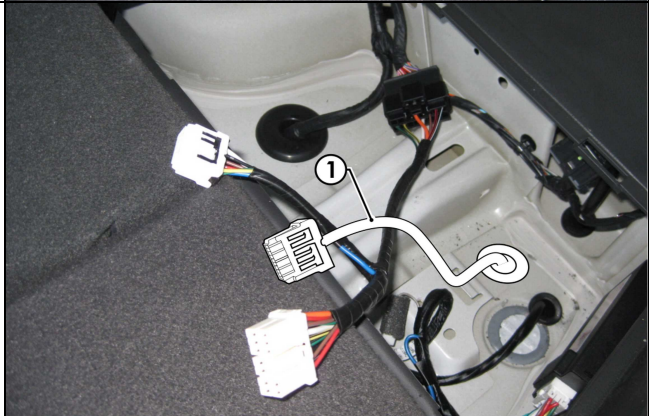

8. Connect the tail harness connector (1) to the trailer patch harness mating connector (2).

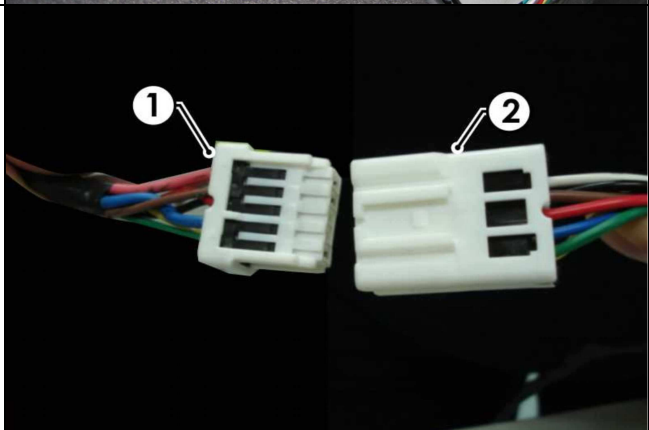

Issue Date 07-07-10

Page 3

Part No: 100405-WL

Hayman Reese (Cequent)  
PO Box 4050, Dandenong South VIC 3164  
Phone 1800 812 017 Email [info@haymanreese.com.au](mailto:info@haymanreese.com.au)

[www.haymanreese.com.au](http://www.haymanreese.com.au)



**HAYMAN REESE  
HOLDEN CAPTIVA  
PART No: 100405-WL**

**INSTALLATION INSTRUCTIONS**

**PLEASE ENSURE THAT INSTRUCTIONS ARE UNDERSTOOD PRIOR TO FITMENT**

9. Connect the 12-way Trailer Patch Connector (2) to the ECU (1).

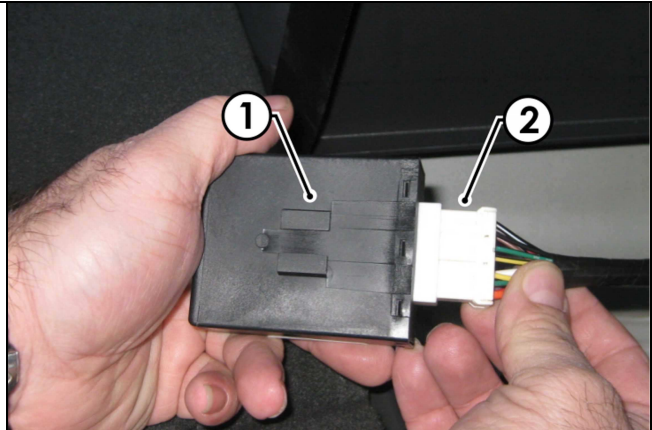

10. Peel the adhesive backing on the ECU (1) and adhere the ECU to the vehicle sheet metal area as show.



11. Test the Trailer Harness function using a Light Board or multimeter.  
12. Secure all Harnesses using cables ties (not supplied).  
13. Refit all removed parts and secure all fasteners, ensuring there are no squeaks or rattles.  
14. Place instructions in glove box after fitment.

Issue Date 07-07-10

Page 4

Part No: 100405-WL

Hayman Reese (Cequent)  
PO Box 4050, Dandenong South VIC 3164  
Phone 1800 812 017 Email [info@haymanreese.com.au](mailto:info@haymanreese.com.au)

[www.haymanreese.com.au](http://www.haymanreese.com.au)





# FITTING INSTRUCTIONS

## Smart Pin (55070BL)

• These fitting instructions are supplied to ensure understanding of how the SMART PIN should be fitted and used correctly.

• Once installed, we recommend **ALL** instructions are kept and placed in the vehicle glove box.

**NOTE: Routine maintenance and inspection of the towbar & SMART PIN is required. Regularly inspect for wear and check the tightness of the SMART PIN NUT. Follow instructions below to retighten the nut when necessary.**

**\*Do not tow with your vehicle if the R CLIP or the SMART PIN NUT is loose or missing. Replacement parts are available from your Hayman Reese Distributor.**

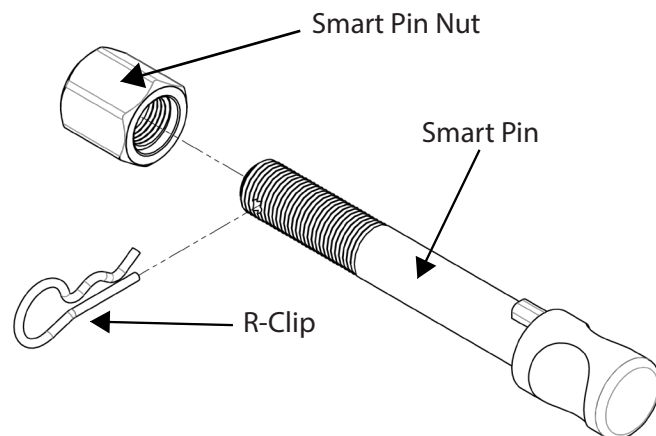
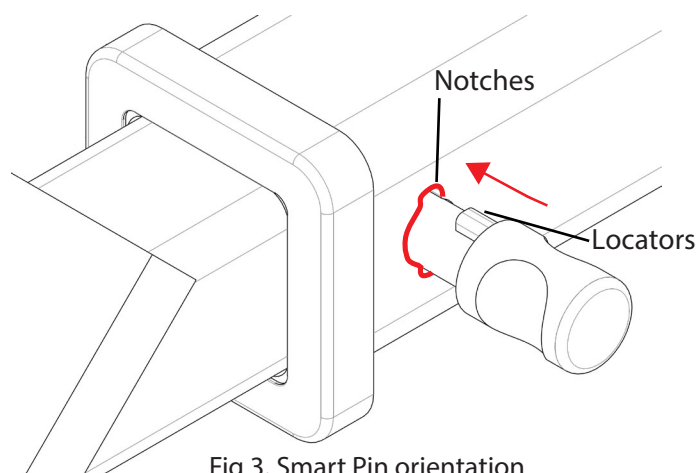
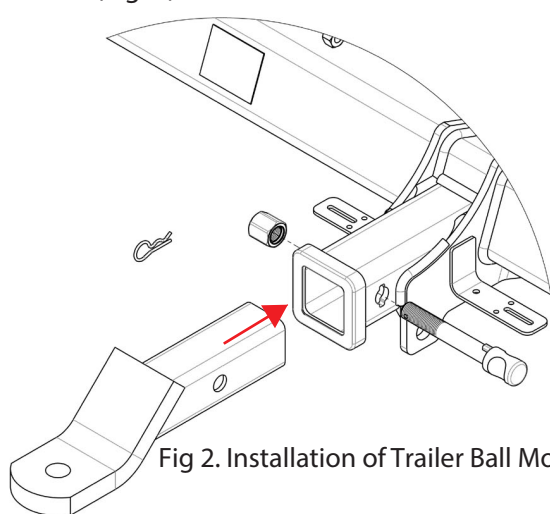

Fig 1. Smart Pin assembly

**STEP 1** Insert Trailer Ball Mount (TBM) into towbar HITCHBOX, aligning hole in TBM SHANK with hole in HITCHBOX (Fig. 2).



**STEP 2** Insert SMART PIN through hole in HITCHBOX and hole in TBM SHANK; ensure the LOCATORS are inserted into the NOTCHES in the HITCHBOX (Fig. 3).

**STEP 3** Screw SMART PIN NUT onto SMART PIN; tighten SMART PIN NUT until finger tight, ensuring TBM is restrained from movement.

**STEP 4** Tighten SMART PIN NUT by turning nut a further 1/8th of a turn in the clockwise direction using a 24mm spanner (Fig 4).

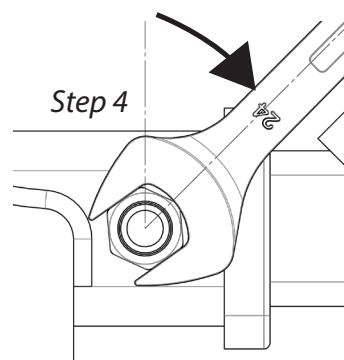

**STEP 5** Install SMART PIN R CLIP through the hole on the SMART PIN (Fig. 1).

