

# Fitting Instructions



## SKU

**TXR851**

## PRODUCT

**TAG 4x4 Recovery Towbar for Great Wall Cannon (09/2020 - on)**

## SPECIFICATIONS

- Towbar Class: 4 Heavy Duty XR
- Towing Capacity: 3500kg
- Tow ball Weight: 350kg
- Recovery Point WLL: 4000kg
- Approx. Fitment Time: 90 Minutes



Scan for latest  
version of these  
instructions

## TOOLS REQUIRED

- Spanners
- Sockets
- Air Saw or similar.
- Trim Removal Tool
- Torque Wrench

## IN THIS GUIDE

- Fitment Instructions
- Torque Settings
- Warranty Info

# Towbar Assembly

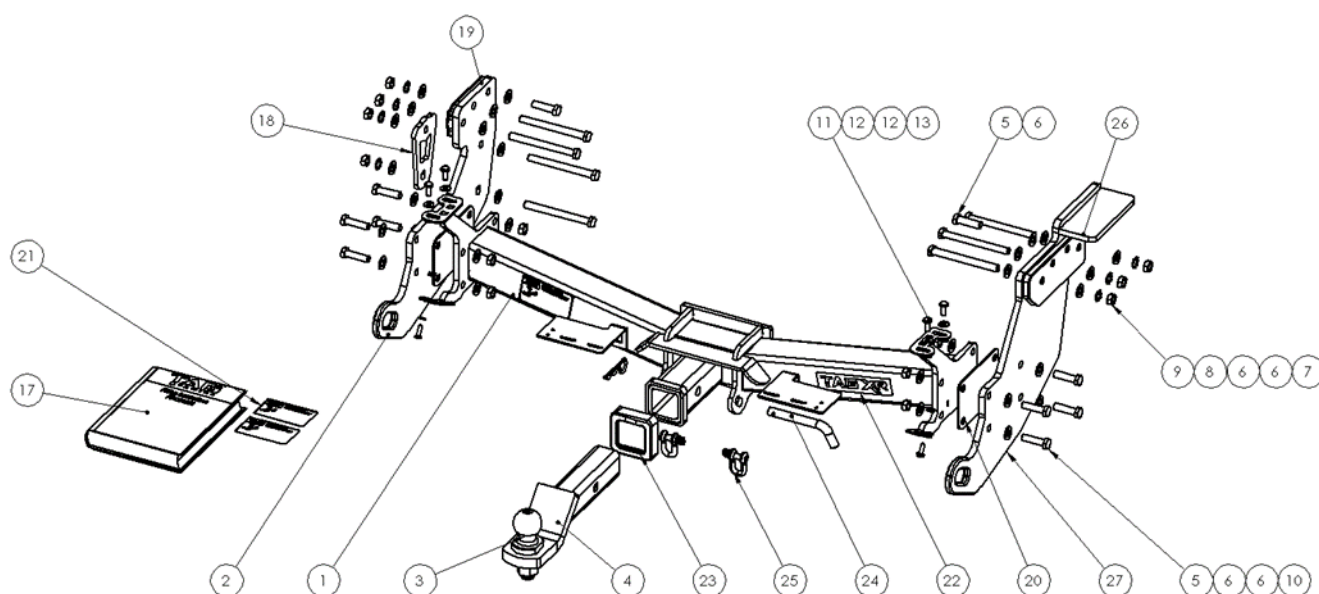

Item No.	Description	QTY.	Item No.	Description	QTY.
1	TXR851 Centre Assembly	1	15	M6 Flat Washer	2
2	PS Endplate Assembly	1	16	M6 x 1.0 Flange Nut	2
3	50mm TAG Tow Ball - Zinc Plated	1	17	Fitting Instruction	1
4	L4045 DURATEC PC TBM	1	18	End Plate Doubler - Lower PS	1
5	M12 x 1.25 x 45 Set Screw 10.9	10	19	Upper Spacer - PS	1
6	M12 Flat Washer	32	20	End Plate spacer	2
7	M12 x 130 x 1.5 Hex Bolt 10.9	7	21	TAG Compliance Sticker	3
8	M12 Shakeproof Washer	7	22	TAG XR Sticker 150 x 33mm	1
9	M12 x 1.5 Nut 10.9	7	23	TAG Hitch Cover	1
10	M12 x 1.25 Nut 10.9	8	24	Class 4 Pin & Clip	1
11	M8 x 1.25 x 20 Set Screw	4	25	D-Shackle - 10mm. 1000kg	2
12	M8 Flat Washer	4	26	Upper Spacer - DS	1
13	M8 x 1.25 Flange Nut	4	27	DS Endplate Assembly	1
14	M6 x 1.0 x 20 Hex Set Screw	2			

# Important Information



## Warning:

- This product is for towing purposes only and must only be loaded as shown in your vehicle Owner's Manual.
- This towbar is NOT to be drilled, cut, welded, or modified in any way.
- Check behind chassis rail and body panels before drilling to ensure no hazards are present.
- All load ratings shown are under the assumption your trailer has a functional braking system installed.
- When installed in positions other than the one depicted in these instructions the Tow Ball Mount may interfere or obstruct certain features of your vehicle (tailgate opening, Chassis clearance, etc.)

## General:

- Before fitting this towbar read fitting instructions and check installation hardware is correct.
- Check that the towbar is suitable for the vehicle and be wary of any changes to the vehicle design that may conflict with the fitting of this towbar. (Tray, Canopy, Suspension etc.)
- After drilling, blow any filings clear, remove any burrs and treat exposed metal with a rust inhibitor.
- The high tensile fasteners supplied with this product are an integral feature to achieving the specified rating, if replacement is required ensure that fasteners of the same grade (8.8) & quality are used. Contact an authorised TAG distributor or the TAG fitment center - (07) 3208 3022 - if further information is required.

## Towbar Maintenance and Care:

It is recommended, when not in use, that the Tow Ball Mount assembly and class 4 Pin and Clip is stored inside the car away from moisture to prevent standing water from forming rust. Inspect to ensure, on regular basis, fasteners are torqued to the specifications below and in good condition.

Ensure that the fitting instructions are read and understood prior to fitment, Following the fitment place these instructions in the vehicle's glovebox after installation is completed.

*Metric Bolt Torque Settings*

Diameter	Pitch	Grade	Torque	Unit		Diameter	Pitch	Grade	Torque	Unit
M8	1.25	8.8	29	Nm		M12	1.25	10.9	125	Nm
M10	1.25	8.8	57	Nm		M12	1.50	10.9	105	Nm
M10	1.50	8.8	44	Nm		M14	1.25	10.9	195	Nm
M12	1.25	8.8	101	Nm		M14	1.50	10.9	165	Nm
M12	1.50	8.8	97	Nm		M16	1.25	10.9	295	Nm
M12	1.75	8.8	77	Nm		M16	1.50	10.9	250	Nm
M14	2.00	8.8	122	Nm		50mm Tow Ball	N/A	N/A	300	Nm
M16	2.00	8.8	190	Nm		70mm Tow Ball	N/A	N/A	750	Nm

# Installation Instructions



---

## Step 1: Remove Rear Bumper

---

- a. Disconnect wiring loom from the connector on PS Chassis.
- b. Loosen rear most M12 bolts on chassis and remove nuts.
- c. Remove forward most bolt from chassis.
- d. Repeat on opposite side.
- e. With help to support the bumper, remove the rear most bolts from the chassis and remove bumper. Discard all bolts.

Set bumper aside for further dismantling.



---

## Step 2: Modify Bumper

---

- a. Disconnect the reverse sensors and the plug from each number plate light.
- b. Release the remaining wiring loom from its fastening points leaving the lane assist sensor plugs attached.
- c. Remove the number plate lights from the outside by releasing the inner plastic loop tab from behind.
- d. Remove 6x 10mm head bolts from the underside of the bumper & 2x 10mm head bolts from the number plate area.
- e. Starting at the outer most corner of the bumper, pull the black plastic step cover upward whilst releasing the clips from inside.
- f. Using a trim puller or similar gently pry the black step cover until the skin releases. Repeat on opposite side.
- g. Set the step cover aside.
- h. Remove 15x M6 Philips head screws from top face of bumper skin attaching to steel bumper re-enforcement. Set it aside.
- i. Separate the plastic skin can from the steel bumper re-enforcement.
- j. Remove 2x 13mm head bolts fastening each of the bumper brackets. Discard brackets & bolts



---

## Step 3: Fit Towbar

---

- a. Mount the PS end plate to the chassis with the upper spacer between the end plate and chassis. Insert 2x M12x 130 bolts & flat washers into the rear most holes. Loosely secure with nuts & washers on the outside. Insert 1x M12x 1.25x 45 bolt & washer into the forward captive thread.
- b. Insert the end plate doubling plate to the outer face of the recovery point tower. Loosely secure with the remaining M12x 130 bolts, washers & nuts.
- c. Mount the DS endplate to the chassis with the upper spacer between the end plate and chassis. Insert 3x M12x 110 bolts & flat washers into rear most holes. Loosely secure with nuts & washers on the outside. Insert 1x M12x 1.25x 45 bolt & washer into the forward captive thread.
- d. Lift the towbar crossmember up to the endplates and loosely secure with 8x M12x1.25 bolts, washers & nuts. Use the 3mm endplate spacers should there be a gap suitable.
- e. Beginning at the chassis, tighten all bolts according to the torque specification on page 3.

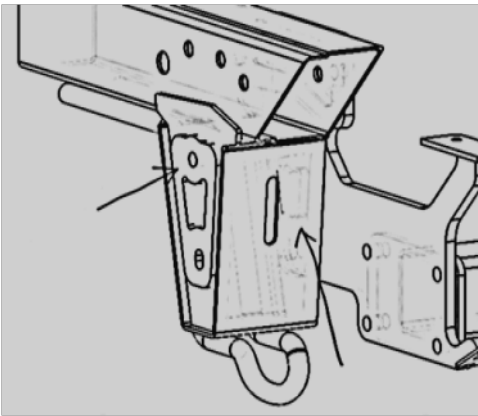

---

## Step 4: Fit Bumper

---

- a. Mount the bumper steel re-enforcement to the endplates using the M8x 20 bolts, washers & nuts. Align with the vehicle and tighten all bolts.
- b. Assemble bumper bar in reverse of Step 2 (a - i).
- c. Use the 2x M6x 20 bolts, washers & nuts provided to fasten the bumper to the lower tab of the endplates.
- d. Re-connect the wiring loom to the connector on PS Chassis.



# Installation Instructions



---

## Step 5: Complete Towbar & Apply Spare Compliance Label

---

- a. Attach TAG Hitch cover with rubber mallet carefully to prevent breaking.
- a. Attach Tow ball to Ball Mount and slide into receiver. Secure with Pull pin and Clip if you are going to tow straight away. Alternatively, secure the Ball Mount in a safe place inside your vehicle.
- b. Apply one of the compliance labels to the pillar of the driver's door. Leave the remaining label and the fitting instructions in the vehicle handbook.



# TAG Warranty Statement



SWD warrants your TAG Towbar for its full product life under the following conditions:

- You can show proof of purchase.
- The towbar has been correctly installed by a suitably qualified installer.
- The towbar has not been modified or abused in any way and has only been used for the purpose intended.
- The towbar was not fitted second hand to your vehicle.

The extent of this warranty includes materials and workmanship used in the manufacture of the towbar and is to the equivalent value of current, full replacement cost.

Nothing stated or implied in this warranty limits in any way, the statutory rights that you may have.

To make a claim visit the original installer in the first instance or, if you are unable to or are not satisfied with their help, then contact us direct by phone on 1300 669122 or visit [www.swd.com.au](http://www.swd.com.au).